

complete the scheme a flexible studio theatre seating about 200 has been constructed in place of the old tunnel-like entrance.

Apart from its grand classical façade and beautifully decorated plaster ceiling there was little left of Coopers' Hall which was worth preserving. Years of neglect and abuse had left their mark and offered an opportunity for complete internal reconstruction so that this building could be transformed into a spacious foyer linked to the existing theatre, giving two historical buildings a new lease of life.

What used to be minor openings in the plinth of the building have been turned into the main entrances. Three pairs of armour-plate glass doors lead into the foyer with booking office. The old floor which divided the hall into two, a banqueting hall over a barrel

*Bristol Old Vic: New foyer in Coopers' Hall.*

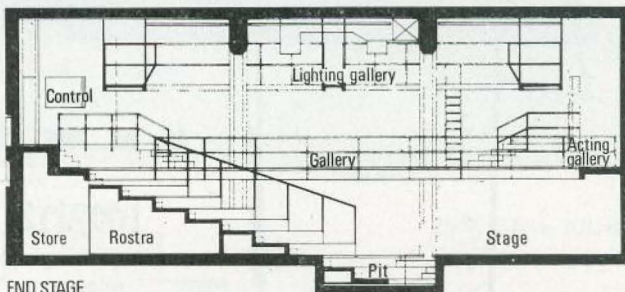

END STAGE

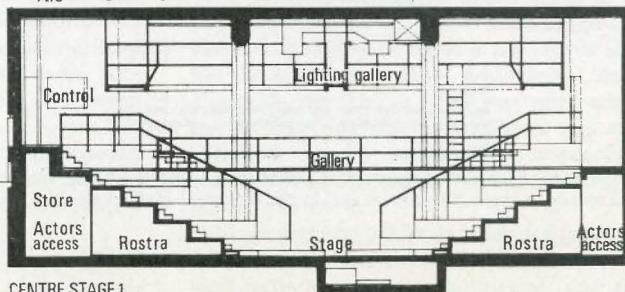
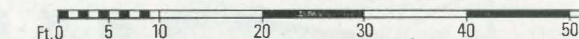

CENTRE STAGE 1

*Bristol Old Vic: Studio Theatre (the New Vic). Sections showing end stage and centre stage formations.*