

shown on the plans as Leningrad Square, an exclusively pedestrian area. When complete this open space will doubtless be aesthetically satisfying, especially on a warm summer evening; but hey, ho, the wind and the rain could well deter some less hardy potential customers during the winter. In view of the space available, access for coaches and cars to unload at the main entrance would have been considerable. There is, however, access to a not very clearly indicated rear entrance opposite to the large car park and, when the customers have found their way about the complex, this is likely to be used a lot. The main entrance leads directly (the rear

entrance more deviously) to the large concourse which serves as foyer to theatre, bars, restaurant, library and multi-purpose halls: its 900 square yards of floor space is also intended to serve as an exhibition area. The decor is rather sombre and the fluorescent lighting hardly helps the female of the species to achieve impact of maximum glamour on arrival.

Altogether one cannot avoid a suspicion that the restrained municipal aesthetics could discourage the proletarian pleasure seekers from taking full advantage of the amenities so generously provided for them. The addition of a little tasteful vulgarity would seem to be needed to relieve the

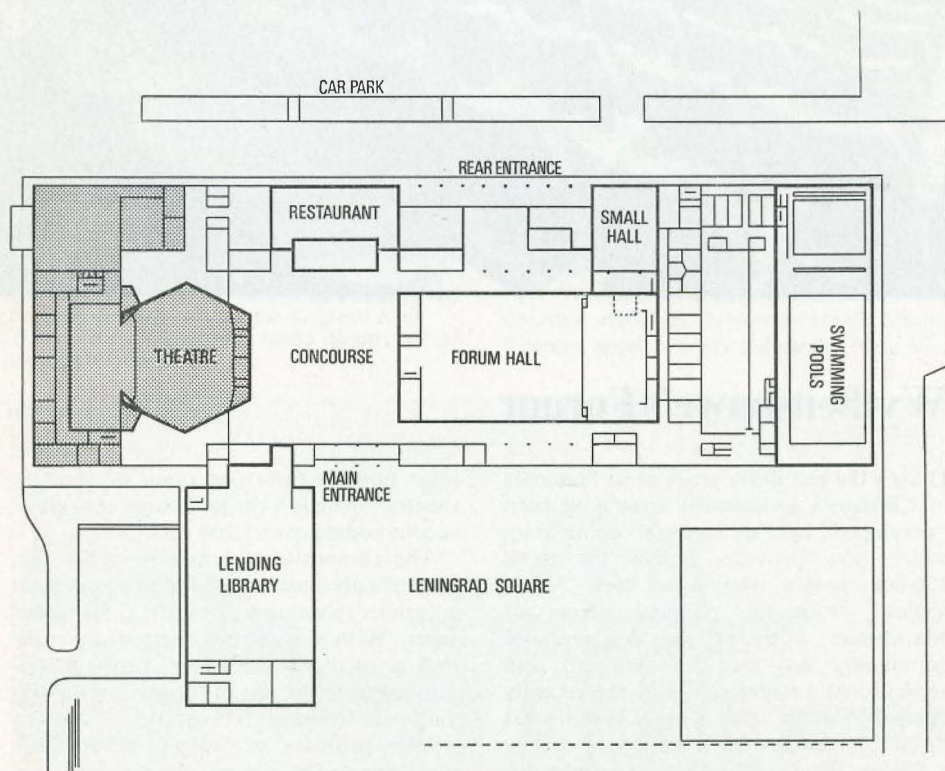

*Wythenshawe Forum. Left: Block plan of the complex. Right: Plan and section of theatre. Architects: Manchester City Architects Dept. S. G. Besant Roberts.*