



PAR

Daylight Parlights



PAR

Daylight Parlights

Strand Quartzcolor's new PARs are the only range of Parlights designed from the beginning as a complete family. They have been developed specifically for the location lighting market, following extensive consultation with many international industry professionals. The unique features of the range are designed to meet the most demanding criteria of cinematographers, directors of photography, gaffers, lighting directors and rental houses. No other range of Parlights in the market today provides as many benefits as the new Strand Quartzcolor range, with its superior optics, ease of use and ease of maintenance.

- A complete family: from 200 W to 12 kW, using single-ended lamps
- Specifically designed lenses and reflectors, giving superior optical performance
- Exceptional light quality and output - the brightest in their class
- High quality, rugged, durable
- Corrosion resistant, for longer life
- IP23 rated, so the unit can be used outdoors in humid conditions
- Compatibility of parts throughout the range
- A comprehensive selection of accessories, interchangeable with existing Quartzcolor products
- Easy to service and maintain: only 4 screws to remove to reach lampholder and spot/flood mechanism
- Scratch resistant black non-reflective housing
- ON-OFF buttons, operated from both head and ballast
- Bonding eyes and rigging hooks on larger units
- Quick release lamp holder on larger units
- New easy-running barndoor ears
- Performance lenses mounted in colour-coded frames
- All heads supplied with barndoor, a set of lenses in case, and head to ballast cable
- The 200W and 575W PARs are also available as kits, including ballast and flight case
- CE mark, UL and cUL approved

PAR

Daylight Parlights

- PAR 200 W
- PAR 575 W
- PAR 1.2 kW
- PAR 4/2.5 kW
- PAR 12/6 kW



HMI

Daylight Fresnels

- HMI 200 W
- HMI 400 W
- HMI 575 W
- HMI 1.2 kW
- HMI 2.5 kW
- HMI 4 kW
- HMI 6 kW



Strand has been at the forefront of film and television lighting for many years. Our acclaimed Quartzcolor luminaires and accessories are renowned worldwide for their high-quality, reliability and lighting performance.

Strand is the leading manufacturer of lighting, dimming and control systems for film, television, theatrical and architectural applications. Our name is synonymous with the best in lighting innovation, quality and professionalism.

With our 10 international commercial offices, our three internationally-based, quality accredited factories, and our global network of distributors and dealers, Strand offers a unique proposition - the capability to design, provide, install and maintain complete lighting systems, for projects of any size.

No other professional lighting company offers a more comprehensive service and complete product catalogue.



PAR 200 W

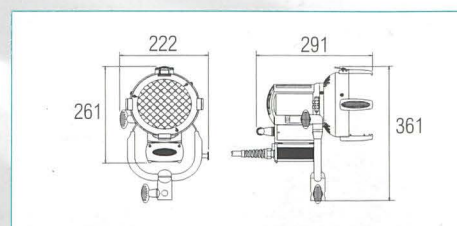
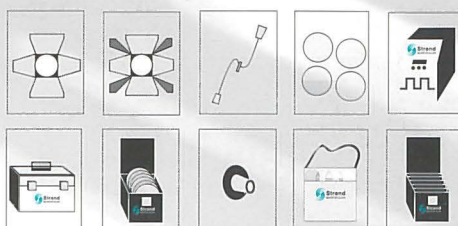

Photometric data • Typical performance with HMI / MSR 200 W

Throw (m)		5	7	10	15
		Lux	Lux	Lux	Lux
Super Spot	(3.3°)	28,000	14,290	7,000	3,110
Narrow Spot	(6.8°)	11,120	5,670	2,780	1,240
Narrow Flood	(9.5°x21.3°)	4,000	2,040	1,000	450
Medium Flood	(18.3° x 40°)	1,560	790	390	170
Extra Wide Flood	(43.5°)	720	370	180	80
Frosted Fresnel	(30.3°)	540	280	130	60

Weight: 3.4 Kg

Volume (kit): 360 x 770 x 350 mm

Lens diameter: 150 mm

PAR 575 W

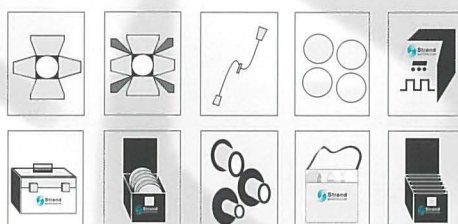
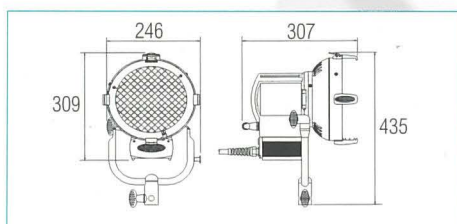

Photometric data • Typical performance with HMI / MSR 575 W

Throw (m)		5	10	15	20
		Lux	Lux	Lux	Lux
Super Spot	(3.8°)	69,200	17,300	7,690	4,320
Very Narrow Spot	(4°)	62,000	15,500	6,890	3,880
Narrow Spot	(6°)	35,720	8,930	3,970	2,230
Narrow Flood	(9.8° x 22.8°)	10,600	2,650	1,180	660
Medium Flood	(18.5° x 53.8°)	2,820	700	315	180
Extra Wide Flood	(68.8°)	1,130	280	125	70
Frosted Fresnel	(38.5°)	990	250	110	60

Weight: 4.6 Kg

Volume (kit): 360 x 770 x 350 mm

Lens diameter: 200 mm





PAR 1.2 kW

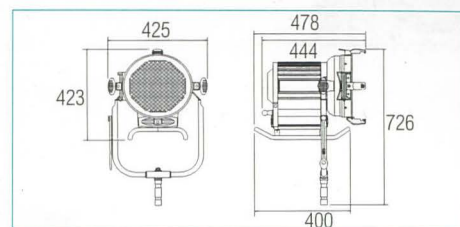
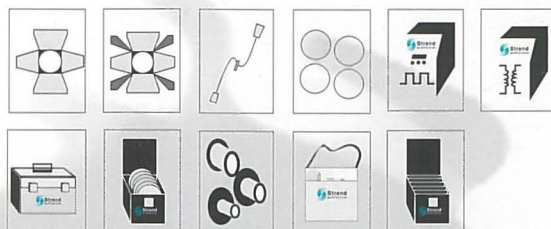

Photometric data • Typical performance with HMI / MSR 1200 W

Throw (m)		5	10	15	20
		Lux	Lux	Lux	Lux
Super Spot	(4.3°)	177,200	44,300	19,690	11,080
Narrow Spot	(5.5°)	96,800	24,200	10,760	6,050
Narrow Flood	(9.5° x 20°)	27,680	6,920	3,080	1,730
Medium Flood	(17.5° x 41.3°)	8,800	2,200	980	550
Extra Wide Flood	(35.3°)	6,000	1,500	670	380
Extra Wide Flood	(63.8°)	2,360	590	260	150
Frosted Fresnel	(44°)	2,080	520	230	130

Weight: 12.7 Kg

Volume: 510 x 460 x 540 mm

Lens diameter: 250 mm

PAR 4 / 2.5 kW

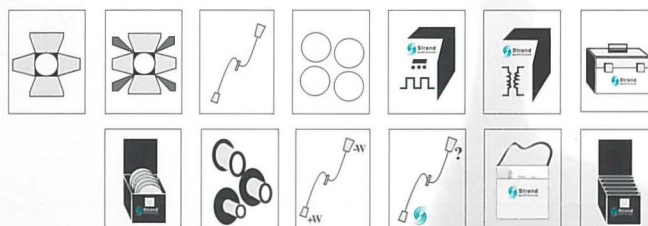
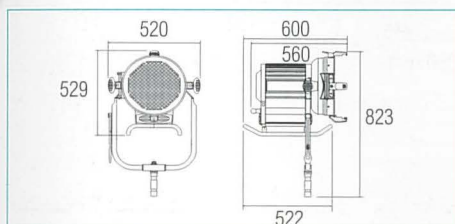

Photometric data • Typical performance with HMI / MSR 4000 W

Throw (m)		5	10	15	20
		Lux	Lux	Lux	Lux
Super Spot	(5.8°)	404,000	101,000	44,980	25,250
Narrow Spot	(8.5°)	201,600	50,400	22,400	12,600
Narrow Flood	(10° x 21°)	100,800	25,200	11,200	6,300
Medium Flood	(19.2° x 44°)	31,200	7,800	3,470	1,950
Extra Wide Flood	(34.5°)	24,200	6,050	2,690	1,510
Extra Wide Flood	(47.8°)	8,280	2,070	920	520
Frosted Fresnel	(29.7°)	9,800	2,450	1,090	610

Weight: 15.5 Kg

Volume: 610 x 640 x 750 mm

Lens diameter: 350 mm



Photometric data • Typical performance with HMI / MSR 2500 W

Throw (m)		5	10	15	20
		Lux	Lux	Lux	Lux
Super Spot	(5.8°)	400,000	100,000	44,450	25,000
Narrow Spot	(8.5°)	165,200	41,300	18,360	10,320
Narrow Flood	(10° x 21°)	66,800	16,700	7,420	4,170
Medium Flood	(19.2° x 44°)	20,080	5,020	2,230	1,260
Extra Wide Flood	(38.8°)	17,560	4,390	1,950	1,100
Extra Wide Flood	(59.7°)	7,600	1,900	840	480
Frosted Fresnel	(29.7°)	6,000	1,500	670	380



PAR 12 / 6 kW

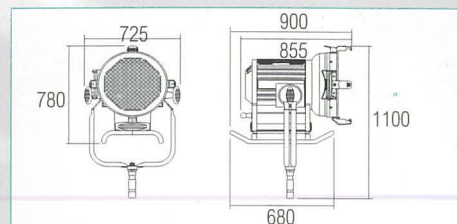
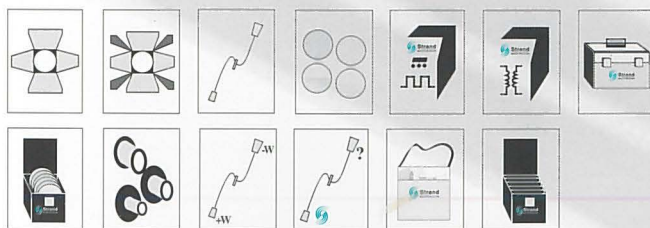

Photometric data • Typical performance with HMI / MSR 12000 W

Throw (m)		10	25	50	75
		Lux	Lux	Lux	Lux
Super Spot	(3.5°)	211,000	33,760	8,440	3,751
Narrow Spot	(8.3°)	82,100	13,140	3,280	1,460
Narrow Flood	(13° x 21°)	36,800	5,890	1,470	650
Medium Flood	(21° x 40°)	15,300	2,460	610	270
Extra Wide Flood	(40°)	12,000	1,820	480	210
Extra Wide Flood	(47°)	1,940	310	80	35
Frosted Fresnel	(44.7°)	5,030	500	200	90

Weight: 60 Kg

Volume: 880 (+140) x 1300 x 570 mm

Lens diameter: 450 mm

Photometric data • Typical performance with HMI / MSR 6000 W

Throw (m)		10	25	50	75
		Lux	Lux	Lux	Lux
Super Spot	(4°)	168,000	26,880	6,720	3,000
Narrow Spot	(7.8°)	66,600	10,640	7,680	1,180
Narrow Flood	(12° x 21°)	26,300	4,210	1,060	470
Medium Flood	(20° x 40°)	9,780	1,570	390	170
Extra Wide Flood	(37°)	7,560	1,210	300	130
Extra Wide Flood	(44°)	6,250	1,000	250	110
Frosted Fresnel	(44.7°)	2,560	410	100	45

Ballasts

Strand Quartzcolor offers a comprehensive range of high specification electronic ballasts from 200 W to 12 kW, in addition to our proven range of extremely reliable compact magnetic ballasts.

Strand Quartzcolor's electronic ballasts offer many unique features:

- Flicker-free for filming at low and high speed
- Power factor corrected from 4 kW to 12 kW, for lower power consumption
- Dimmable to 50%
- Light weight
- Dual wattage, so you can run lamps of different wattage from the same ballast
- Multi-voltage, from 110 to 240 V with auto-sensing
- Line over voltage and under voltage protection
- Over temperature protection
- Operations and diagnostic log system on most models
- Infra-red data key



Flight Cases

A range of smart, rugged, high quality flightcases has been specifically designed to protect your PAR lenses and lighting kits.

- Scratchproof surface
- Metal plates on all corners
- Flush handles
- Heat resistant interior
- Easy storage



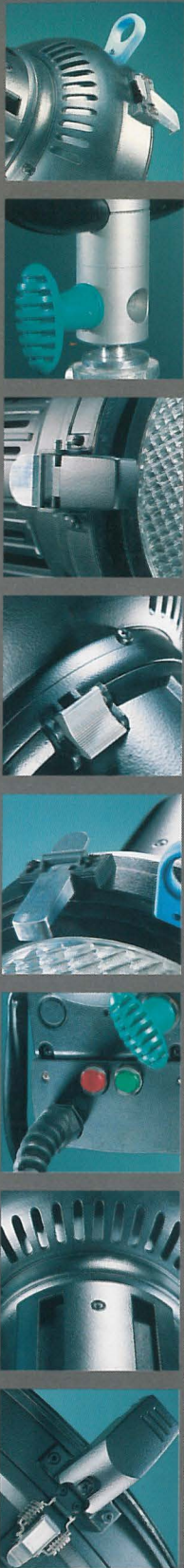

Strand Lighting Ltd
North Hyde House, Hayes Road,
Heston, Middlesex UB2 5NL, UK.
Tel: +44 (0) 181 571 3588 Fax: +44 (0) 181 571 3305

Strand Lighting GmbH
Ullsteinstrasse 114-142
D-12109 Berlin, Germany
Tel: +49 (0) 30/70 79 51 0 Fax: +49 (0) 30/70 79 519 9

Strand Lighting Italia S. r. l.
Via delle Gardenie, 33
00040 Pomezia (Roma), Italia
Tel: +39-0691963.1, Fax: +39-069147136

Strand Lighting
1 Rue de l'Arc de Triomphe
75017 Paris, France
Tel: +33 (0) 1 55370033 Fax: +33 (0) 55370233

Strandlighting Ltd
Novinsky Boulevard 20 A, Buildings 3-6
12069 Moscow, Russia
Tel: +7 095 290 2092 Fax: +7 095 290 1736

Strand Lighting Inc
18111 South Santa Fe Avenue
Rancho Dominguez, CA 90221, USA
Tel: +1 310 637 7500 Fax: +1 310 632 5519

Strand Lighting Inc.
2nd Floor, 151 West 25th Street
New York, NY, USA
Tel: +1 212 242 1042 Fax: +1 212 242 1837

Strand Lighting (Canada) Inc / Eclairages Strand (Canada) Inc
2430 Lucknow Drive #15
Mississauga, Ontario L5S 1V3, Canada
Tel: +1 905 677 7130 Fax: +1 905 677 6859

Strand Lighting Asia Ltd
7/F Corporation Square, 8 Lam Lok Street
Kowloon Bay, Hong Kong
Tel: +852 2757 3033 Fax: +852 2757 1767

<http://www.strandlighting.com>



Strand
QUARTZCOLOR

The Company reserves the right to change the design and construction of any articles illustrated. © Strand Lighting Ltd 1998.
Strand™, Strand Lighting™, Strand QuartzColor™ are registered trademarks of Strand Lighting Limited and Strand Lighting Inc.
London - Berlin - Rome - Paris - Moscow - Los Angeles - Toronto - New York - Hong Kong