



Strand Lighting

P R O D U C T D A T A

### Optique 8/17

Variable angle condenser optics profile spotlight with 8° - 17° beam angle and flat field for sharp, long-throw projection of gobos and shutter edges. Optional iris diaphragm or gobo holder.

W 1200W V 230/240V < 8° - 17° 12.6kg  
\* 1480 Lux ◀ 15m X 185 x 185mm M  
15.6kg 0.155m<sup>3</sup> EN60 598 2-17

#### Cat. No. Description

12014	Optique 8/17, CP90, 1200W, 240V lamp, with 15A plug
12013	Optique 8/17, CP90, 1200W, 230V lamp, with Schuko plug

### Optique 15/42

Variable angle condenser optics profile spotlight with 15° - 42° beam angle and flat field for sharp, medium-throw projection of gobos and shutter edges. Optional iris diaphragm or gobo holder.

W 1200W V 230/240V < 15° - 42° 12.6kg  
\* 1180 Lux ◀ 10m X 185 x 185mm M  
15.5kg 0.128m<sup>3</sup> EN60 598 2-17

#### Cat. No. Description

12024	Optique 15/42, CP90, 1200W, 240V lamp, with 15A plug
12023	Optique 15/42, CP90, 1200W, 230V lamp, with Schuko plug

### Optique Accessories

#### Cat. No. Description

41294	Additional CP90, 1200W, 240V lamp
41293	Additional CP90, 1200W, 230V lamp
41194	T19, 1000W 240V lamp
41193	T19, 1000W 230V lamp
18103	Iris, 18-leaf
18100	Holder for M-size gobo
18104	Additional colour frame, metal
55001	Colour Call Scroller CCI
82010	Hook Clamp
82000	Safety cable, light duty (up to 16kg)

# 1.2.3

S P O T L I G H T S

## OPTIQUE™ Condenser Optics 1200W

Optique 8/17

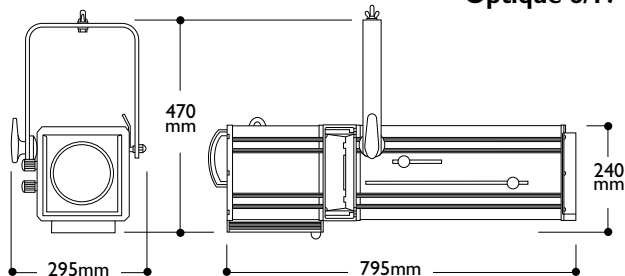

Optique 15/42

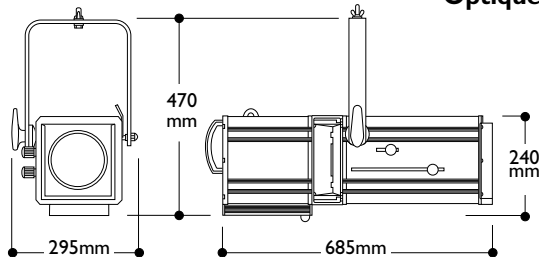

### A GUIDE TO SYMBOLS AND ABBREVIATIONS

**GENERAL** W Supply voltage A Current rating 12 Weight of product 13 Overall dimension of product 14 Packed weight 15 Packed volume 16 Compliance with safety standards. W Watts (maximum recommended) < Beam angle (Field angles for profiles spotlights). ◀ Throw (usual working distance from subject in meters). \* Illuminance (maximum lux at throw distance stated with lamp recommended). M Gobo (pattern) size. 'M' size, 66mm dia, 49.5mm image X Colour filter frame size BS British Standard IP International protection standard

- Condenser optic profile spotlights
- Two zoom profiles cover a wide beam angle range from 8° to 42°
- Smooth flat field is ideal for sharp gobo projection
- Rotatable gate assembly as standard
- CP70 1000W lamp may be used
- New improved lens movement
- Supplied in black finish with CP90 1200W lamp, colour frame, mounting fork with M10 wingnut and bolt, and detachable 1.5m cable with plug
- Available as either 240V version (with 240V lamp and 15A plug) or 230V version (with 230V lamp and Schuko plug)

**Photometric Data**

Typical performance based on CP90 1200W 240V lamp

**Peak Distribution**

Throw (metres)	5	10	12.5	15	20	25
8°-17° (N)		3550	2272	1577	888	570
8°-17° (W)	3840	960	614	427		
15°-42° (N)	4400	1100	710	490		
15°-42° (W)	960	240	153			

**Beam Diameter (m) for Projected Throw in Meters**

Throw (metres)	5	10	12.5	15	20	25
8°-17° (N)		1.39	1.75	2.09	2.79	3.49
8°-17° (W)	1.49	2.98	3.73			
15°-42° (N)	1.31	2.63	3.29	3.94		
15°-42° (W)	3.83	7.67	9.59			

**Peak Intensity, Half Peak and Cut-off**

	1/2 Pk	Candelas	1/10 Pk
8°-17° (N)	7°	355000	8°
8°-17° (W)	12°	96000	16°
15°-42° (N)	13°	110000	15°
15°-42° (W)	24°	24000	37°

For performance of any luminaire divide Candela by Distance<sup>2</sup>**Lamp Data**

Specify Strand lamps for replacement purposes to the following specifications

Volts	230V	240V	230V	240V
Watts	1200W	1200W	1000W	1000W
Designation	CP90	CP90	T19	T19
Base	GX9.5	GX9.5	GX9.5	GX9.5
Lumens	30000	30000	21000	21000
Rated Life-hours	240	240	750	750
Colour Temp	3050K	3050K	3050K	3050K

Volts	230V	240V
Watts	1200W	1200W
Designation	T29	T29
Base	GX9.5	GX9.5
Lumens	29000	29000
Rated Life-hours	400	400
Colour Temp	3050K	3050K

**Electrical Data**

Supply Voltage	230 volts or 240 volts 50/60 Hz
Max Lamp Wattage	1200W
Lamp Type/Base	CP90 or T29 1200W GX9.5 base. T19 1000W GX9.5 base.
Cable/Connection	1.5m toughened silicone rubber detachable power cable terminating in CEE22 angled power connection for connection to luminaire. (15A or Schuko plug shall be specified). Conductors 3 x 1.5mm <sup>2</sup> .
Standards Compliance	Designed to conform with EN 60 598 2-17.



**London:** Strand Lighting Ltd, Grant Way, Isleworth, Middlesex, TW7 5QD, United Kingdom.  
Tel: +44 (0)181 560 3171 Fax: +44 (0)181 568 2103

**Wolfenbüttel:** Strand Lighting GmbH, Salzbergstraße 2, 38302 Wolfenbüttel, Germany.  
Tel: +49 (0) 5331 3008-8 Fax: +49 (0) 5331 78883

**Rome:** Strand Lighting Srl, Via delle Gardenie 33, Pontina Vecchia Km 33,400, 00040 Pomezia-Roma, Italy  
Tel: +39 (0) 6 914 7123 Fax: +39 (0) 6 914 7136

**Brussels:** Strand Lighting Ltd, Chaussée de Haecht 1801, 1130 Bruxelles, Belgium  
Tel: +32 (0) 2 245 8686 Fax: +32 (0) 2 245 2235

**Stockholm:** Strand Lighting Ltd, Box 20105, Tappvägen 24, 161 02 Bromma, Sweden  
Tel: +46 (0) 8 799 6950 Fax: +46 (0) 8 799 6954

ALSO FACILITIES IN: **LOS ANGELES • NEW YORK • HONG KONG • MILANO • MUNICH • BERLIN**

**Environmental Data**

Max Operating Ambient Temp	45°C
Max Surface Temperature	290°C
IP Rating	IP20
Tilt/Recommended angles of use	45° - 0 - 90°

**Mechanical Data**

Paint/Finish	High temperature stoved epoxy powder coat in black.
Lamp House Construction	Pressure diecast aluminium rear panel, aluminium sides and slotted top panels for ventilation. Rear hinging extruded aluminium lampray retained by 1/4 turn fastener.
Lens Tube (Profiles)	Extruded aluminium side panels with pressed steel rear plate, steel top and bottom panels and diecast front panel with extruded aluminium colour runners. Pressed steel lens carriers mounted on diecast sliders running in extruded slot inside panel.
Rear Handle	Vertical, heat insulated handle on rear of lamp housing.
Mounting and Suspension	Mounting fork with M10 wingnut and bolt or DIN 15560 mounting.

**Weights and Dimensions**

	Optique 8/17	Optique 15/42
Weight	12.8kg	12.4kg
Length (Incl handle)	795mm	685mm
Width	295mm	295mm
Height (Incl stirrup)	470mm	470mm
Packed weight	15.9kg	15.4kg
Packed length	915mm	790mm
Packed width	390mm	395mm
Packed height	400mm	390mm
Filter Cut Size	185 x 185mm	185 x 185mm
Colour runner	185mm <sup>2</sup> DIN size metal colour frame fits integral diecast runners with retention spring for single handed insertion and removal.	
Optical system	A condenser optical system is formed from a 60mm modified hemispherical, electro polished, aluminium reflector and an aspherical condenser lens. The gate image is focused using two sets of plano-convex lenses. Each lens is contained by rigid pressure diecast lens carriers. The rear set will contain one (8/17) or two (15/42) plano-convex crown glass lenses. Some lens surfaces have anti-reflective coatings.	
Gobo Size	M	

**Operational Data**

Lamp Access	Rearward hinging lampray provides access after removal of power cable and is retained by a 1/4 turn fastener.
Lens Access	Sliding top covers open for complete access to lenses for cleaning and maintenance.
Focus Adjustment	Lens position adjusted by handles at side of lens tube. Focus setting indication is provided.
Beam Shaping	Four removable beam shaping shutters of steel alloy and fitted in diecast gate assembly which is rotatable through 360° 18-leaf iris and Gobo holder available as accessory.
Tilt	Adjustment by means of pivots on either side of fork, locked by T-handle on interlocking spring cup and disk mechanism.
Pan	Pivot around M10 bolt through centre of fork, or using DIN 15560 mounting.

The Company reserves the right to make any variation in design or construction to the equipment described. © Strand Lighting Ltd 1995. Strand™, Strand Lighting™ and Optique™ are trade marks of Strand Lighting Limited and Strand Lighting Inc. Strand Lighting is a company within the Film & Television Division of The Rank Organisation Plc, United Kingdom. Country of origin United Kingdom.