

LEKOZOOM OPERATING INSTRUCTIONS

Strand Lighting

Strand Lighting Inc., 18111 South Santa Fe Avenue,
P.O. Box 9004, Rancho Dominguez CA. 90221 USA
Tel # 310 637 7500 Fax # 310 632 5519

Strand Lighting, 2430 Lucknow Drive #15, Mississauga,
Ontario, Canada L5S 1V3
Tel # 905 677 7130 Fax # 905 677 6859

Strand Lighting Asia Ltd., 7th Floor Corporation Sq.,
8 Lam Lok St., Kowloon, Bay, Kowloon, Hong Kong.
Tel # 852 2757 3033 Fax # 852 2757 1767

Strand Lighting Ltd., Grant Way, Syon Lane, Isleworth,
Middlesex TW7 5QD.
Tel # 0181 560 3171 Fax # 0181 568 2103

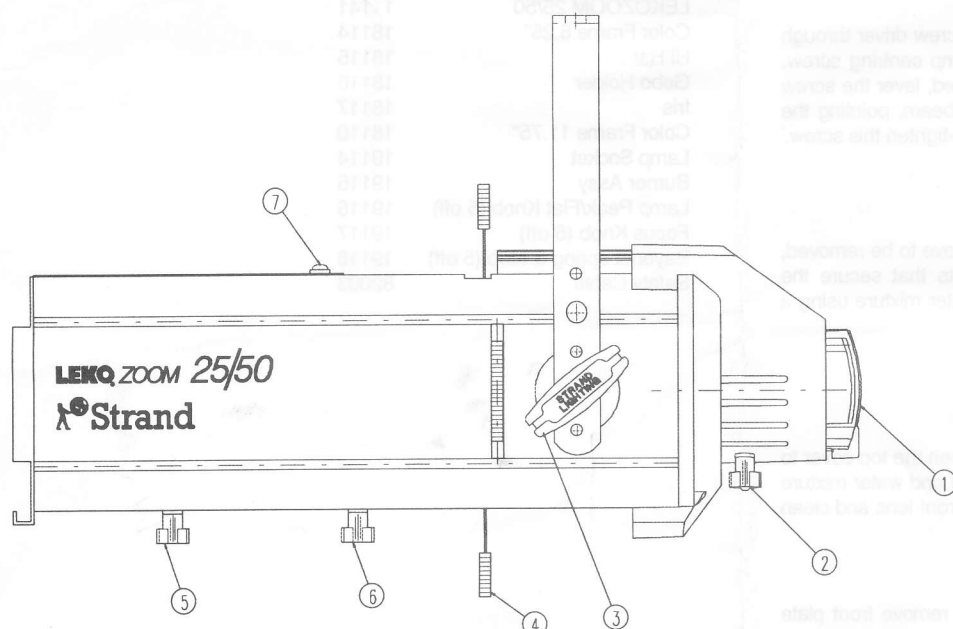

GENERAL

Your LEKOZOOM spotlight has been designed to conform to UL & CSA safety standard. The rating label information on the side of the equipment provides the following information:



On your fixture this symbol will have a number on it. This is the batch number and should be quoted if you have to contact a Strand dealer with any inquiry on the product.

CONNECTING TO THE MAINS

This fixture is supplied with a 36" long power cable rated to 180 °C, fitted as an integral part of the fixture.

WARNING

Before lamping or relamping always disconnect the fixture from both poles of the power supply.

The quartz envelope of tungsten halogen lamps attains a very high temperature. Allow to cool for at least 5 minutes before attempting to remove a lamp.

Follow the lamp manufactures instructions for handling quartz envelope lamps. In particular do not handle the quartz envelope - use the plastic sheath provided with a new lamp.

REPLACEMENT LAMPS

The following lamps are stocked and can be purchased as replacements

ANSI Code	Watts	Life	Color Temp (K)
EHC/EHB	500	200	3200
EHD	500	2000	3000
FLK (HX600)	575	300	3200
(HX601)	575	1500	2800

USER ADJUSTMENTS

RELAMPING

For access to the lampholder, turn the burner handle (1) counter clockwise against the spring pressure after which the burner may be withdrawn from the LEKOZOOM body.

IMPORTANT - Do not loosen the lamp focus knob (2) to remove the burner. This ensures easy refitting and protects previously set beam distribution.

To fit a new lamp, align the pins of the lamp with the appropriate pins on the socket in the lampholder, insert the lamp and push firmly down until the bottom of the ceramic lamp seats.

Replacing the burner is the reverse of the above.

IMPORTANT - The fixture must be disconnected from the supply whilst any work is carried out on the burner.

MOUNTING

The suspension yoke can be fitted with an accessory enabling the fixture to be suspended or stand mounted.

The unit is supplied with a 'C' clamp 82019. The 'C' clamp will then allow suspension from a 2" OD pipe.

Do not mount on or near a combustible surface.

ADJUSTMENT

Having followed the instructions for mounting, the tilt of the fixture can be adjusted by slackening the handwheel (3) on the side of the yoke and adjusting to any usable angle. The handwheel should then be tightened to lock the fixture in position. An adjustment handle is provided on the rear of the fixture to facilitate all adjustments.

NOTE - This handle is not intended for carrying the fixture.

Pan or swivel adjustment is achieved by slackening the lock screw on the 'C' clamp, rotating to the required position and then re-tightening the screw.

FOCUS and BEAM DISTRIBUTION

Before lighting up, ensure beam shaping shutters (4) are in the open position. The beam can be focused on the LekoZoom by loosening the front lens knob (5) and moving the knob to adjust the beam angle (the front lens has detents to aid positional location). The rear lens can be moved by loosening the rear lens knob (6) to adjust the focus. The markings on the bottom of the unit give an indication of beam angle and focus.

Beam size can also be altered by fitting an iris (18117). Slacken screw (7) and slide cover forward, insert Iris into accessory runners and slide top cover back into closed position, tighten screw.

Next set the beam shaping shutters to produce the beam shape required, the top shutter changes the bottom of the projected beam, the right hand shutter, the left hand side of the beam.

The beam distribution can be altered by loosening the lamp focus knob (2) and moving the burner back (for cosine distribution) or forward (for peak distribution).

The lamp can be centred by inserting a Phillips head screw driver through the hole in the rear handle (1) into the head of the lamp centring screw. Loosen this screw and with the screwdriver still engaged, lever the screw against the rear handle to centre the hot spot in the beam, pointing the screw driver in the direction the hot spot should go. Re-tighten this screw.

MAINTENANCE

CLEANING REFLECTOR

To clean the reflector the front plate and rear casting have to be removed, four screws each. Remove the four screws and nuts that secure the reflector. Clean the reflector with a 1:1 alcohol and water mixture using a soft lint free cloth.

Do not use abrasive cleaners.

Replacement is the reverse of the above.

CLEANING LENS

To clean the lenses, slacken the screw (7) and slide open the top cover to gain access to the rear lens. Clean using a 1:1 alcohol and water mixture and a soft lint free cloth. Slide covers back to access front lens and clean in similar manner. Close covers and tighten screw.

REPLACING LENS

To change lenses, release 4 screws on front of unit, remove front plate and slide out the lens assembly. Remove the four screws and washers that retain a lens. Replace the lens noting the orientation. Replacement is the reverse of the above ensuring all screws are secure.

Unit	Front Lens	Rear Lens	Orientation
11141	4.5" x 9"	4.5" x 6.5"	Both Ball Forward
11151	4.5" x 12"	4.5" x 7.7"	Both Ball Forward

REPLACING SHUTTER BLADES

Remove blade by pulling fully out of beam and then rotating in direction of the flat edge of the of the blade, continue to pull and the blade will slide out. Replace by reversing above procedure.

REPOSITIONING YOKE

For compact suspension but with restricted angle of tilt, the yoke can be lowered by unscrewing the yoke lock knob (3) and the retaining screw on the other side. The yoke is then removed from the lamphouse. The inner of the two fixing screws of the spring clamping disc is loosened and the outer one removed. The disc can then be rotated 180° and the loose screw then inserted into the unused fixing hole. The two screws are then tightened and the yoke assembly is refitted on to the repositioned clamp.

REPLACING LAMP SOCKET

First the burner must be removed as for lamp replacement. Disconnect the earth screw inside the burner to remove the burner from the fixture. Remove the two screws in the handle cover and un-hinge the cover. The lampholder leads may then be removed from the terminal block. Using a long Phillips screwdriver, the two screws securing the lampholder to the finned casting can be removed and the lampholder withdrawn. Re-assembly is the reverse of this procedure, taking care to ensure proper reconnection of the new lampholder leads in the terminal block. It may be necessary to loosen the three screws holding the rear handle to aid rewiring.

ACCESSORIES

An iris 18117 or Gobo holder 18116 can be inserted through the slot in the lens tube. The accessory slides into the runners.

ORDERING INFORMATION

LEKOZOOM 18/30	11151
LEKOZOOM 25/50	11141
Color Frame 6.25"	18114
Hi Hat	18115
Gobo Holder	18116
Iris	18117
Color Frame 11.75"	18110
Lamp Socket	19114
Burner Assy	19115
Lamp Peak/Flat Knob (5 off)	19116
Focus Knob (5 off)	19117
Bayonet spring & stop (5 off)	19118
Safety Cable	82003

Strand Lighting

The company reserves the right to make any variation in design or construction to the equipment described.

LEKO is a trade mark of Strand Lighting Limited.

Strand and Strand Lighting are registered trade marks.

Strand Lighting is a company within the film and television division of The Rank Organisation, United Kingdom.

40/B876

Iss 2

Strand Lighting Ltd © 1995