

Strand Lighting

P R O D U C T D A T A

### Hyperbeam 1200

A dynamic remotely controlled performance spotlight, designed for effect lighting of musicals and light entertainment shows. The unit directs the light beam using a remotely controlled pan/tilt diverting mirror. It also has the following built-in remotely controlled devices:- dimming shutter and strobe, one colour wheel with 9 colours and open white, two gobo wheels, one containing 9 fixed patterns, the other 4 rotatable patterns, focus control, Iris, and Prism wheel.

The unit is supplied with an adjustable mounting bracket.

W 1200W V 100/120/230/240/250V 50/60Hz  
 ◀ 18.5° ⚖ 49kg (107.8lb) 📦 59kg (129.8lb)  
 📦 0.0998m<sup>3</sup> (3.52cu ft)

Cat. No.	Description
17570	Hyperbeam 1200 100V to 250V, 1200W

### Hyperbeam 1288

A dynamic remotely controlled performance spotlight, designed for effect lighting of musicals and light entertainment shows. The unit directs the light beam using a remotely controlled pan/tilt diverting mirror. It also has the following built-in remotely controlled devices:- dimming shutter and strobe, two dichroic colour wheels with 9 colours and open white, two gobo wheels, one containing 9 fixed patterns, the other 4 rotatable patterns, focus control, Iris, and Prism wheel. It has an infinite colour mixing system, using Cyan, Magenta, and Yellow dichroic colours.

The unit is supplied with an adjustable mounting bracket.

W 1200W V 100/120/230/240/250V 50/60Hz  
 ◀ 18.5° ⚖ 53kg (116.6lb) 📦 62kg (136.4lb)  
 📦 0.0998m<sup>3</sup> (3.52cu ft)

Cat. No.	Description
17580	Hyperbeam 1288 100V to 250V, 1200W

### A GUIDE TO SYMBOLS AND ABBREVIATIONS

**GENERAL** W Supply voltage V Current rating ⚖ Weight of product 📦 Packed weight 📦 Packed volume  
 ◀ Overall dimension of product ✓ Compliance with international standards. W Watts (maximum recommended) ◀ Beam angle (Half-peak angles for Fresnels and PCs. Cut-off angles for profile spotlights)  
 IP International Production Standard



# HYPERBEAM™

## 1200 & 1288 Automated Spotlight 1200W

### Hyperbeam 1288

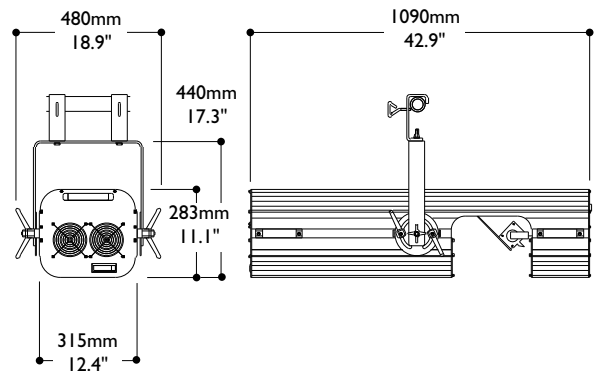

- Two tough performers, future protected by unique modular design
- Uses 1200 Watt MSR lamp
- Accepts DMX512 control protocol with 8 or 16 bit resolution
- Cyan, magenta and yellow colour mixing (Hyperbeam™ 1288 only)
- 175° pan in 0.028° of resolution, 85° tilt in 0.056° of resolution
- Remote lamp on/off
- Four selectable control modes
- Two colour wheels with 9 dichroic colours plus open white (Hyperbeam™ 1200 has only one wheel)
- Two gobo wheels, one with 9 pre-aligned patterns, the second with four rotatable patterns
- Easy luminaire addressing and menu set-up using 4-digit display
- Remote controlled fan speed for quieter operation
- Multiplying prisms and frost filter effects
- Variable shutter speed control for strobe effects
- Remote control of focus, iris and intensity
- Selectable supply voltage options: 100/120/230/240/250V at 50/60Hz

**Lamp Data**

Specify lamps for replacement purposes to the following specifications.

<b>Watts</b>	1200W
<b>Designation</b>	MSR
<b>Base</b>	G38
<b>Lumens</b>	110000
<b>Rated Life-Hours</b>	750
<b>Colour Temp</b>	5600K
<b>Lamp Control</b>	Can be switched on and off remotely from console. (Not hot re-strike)

**Electrical Data**

<b>Supply Volts</b>	100V-250V 50/60Hz
<b>Power</b>	1550W
<b>Consumption</b>	
<b>Max Lamp Wattage</b>	1200
<b>Lamp Type/Socket</b>	MSR G22
<b>Cable/Connections</b>	Supplied with 1 metre (3.3') power cable.

**Environmental Data**

<b>Max Operating Ambient Temp</b>	35°C (95°F).
<b>IP Rating</b>	IP20.

**Mechanical Data**

<b>Construction</b>	Rugged extruded aluminium inter-linking shells with two aluminium end plates. The rigid structure protects the internal modular design from the rigours of rigging. All modules are easily accessible for cleaning or future upgrades.
<b>Mounting / Suspension</b>	Adjustable mounting yoke. (Two heavy duty hook clamps are required with heavy duty safety cable).

**Weights and Dimensions**

<b>Weight (1200)</b>	49kg (107.8lb)
<b>Weight (1288)</b>	53kg (116.6lb)
<b>Length</b>	1107mm (43.6")
<b>Width (body)</b>	316mm (12.4")
<b>Width (overall)</b>	462mm (18.2")
<b>Height (body)</b>	285mm (11.2")
<b>Height (overall)</b>	450mm (17.7")
<b>Packed Weight (1200)</b>	59kg (129.8lb)
<b>Packed Weight (1288)</b>	62kg (136.4lb)

**Optical System**

<b>Beam Direction</b>	Steered by a diverting mirror which can switch direction almost instantaneously as well as move with stealth.
<b>Colour Control</b>	Two separate colour wheels (1200 version has one), each with 9 dichroic colours and open white can be used individually or combined. Micro-stepping motors allow mixing of adjacent colours in the same beam or slowly change the colour of the beam live. Colour wheels can rotate continuously in either direction.
<b>Colour Mixing</b>	The Hyperbeam™ 1228 has a dichroic colour mixing system, using cyan, magenta and yellow. Operators can design the hue of the beam. Colours can be programmed to fade between each other or 'snap' to a new colour. Strand 430/530™ consoles with Tracker™ software can command groups of units to go to pre-programmed colours.

**Operational Data**

<b>Set Up</b>	The menu-driven set-up system uses a 4 digit LED display. One of four operating modes may be selected for each unit. The Hyperbeam™ set-up or Tracker™ application software allows many orientations without affecting intuitive control of beam movement. This is done by inversion of the Pan and Tilt direction and swapping of control channels in any combination.
<b>Control</b>	Both luminaires are controlled through Tracker™ application software on Strand 430/530™ consoles using DMX512 protocol, providing intuitive motion control. Intensity control is achieved by using a micro-stepping shutter capable of 0-100% control. Tracker™ application software places the function on the consoles intensity control wheel and operates like any other dimming function. Also able to control luminaires with other lighting consoles outputting DMX512 (1990). Accepts Martin professional protocol.
<b>Fan Speed</b>	The speed of the cooling fan can be reduced remotely when extra quiet operation is required.
<b>Beam Direction</b>	Tilt 85° arc Pan 175° arc.
<b>Pattern Control</b>	Nine fixed patterns plus open are provided in a gobo wheel. Wheel is rotated at variable speeds in either direction, and stopped by micro-stepping on complete or joining images. A second gobo wheel has four rotatable patterns plus open. Stationary patterns can be programmed into 255 different alignments.
<b>Effects Disk</b>	Two types of prism splitting into 3 or 5 beams. Frost filters provide to diffuse beam edge. The Hyperbeam™ 1200 includes two Colour Temperature Correction filters, on the Hyperbeam™ 1228 these are included in the second colour wheel.
<b>Focus Adjustment</b>	The focus of pattern, prism or iris can be remotely controlled.
<b>Lamp Access</b>	Via removable extruded aluminium cover.
<b>Pan &amp; Tilt</b>	8-bit DMX512 available for each axis.

**Strand Lighting**

**London:** Strand Lighting Ltd, Grant Way, Isleworth, Middlesex, TW7 5QD, United Kingdom.  
Tel: +44 (0)181 560 3171 Fax: +44 (0)181 568 2103

**Wolfenbüttel:** Strand Lighting GmbH, Salzbergstraße 2, 38302 Wolfenbüttel, Germany.  
Tel: +49 (0) 5331 3008-8 Fax: +49 (0) 5331 78883

**Rome:** Strand Lighting Srl, Via delle Gardenie 33, Pontina Vecchia Km 33,400, 00040 Pomezia-Roma, Italy  
Tel: +39 (0) 6 914 7123 Fax: +39 (0) 6 914 7136

**Brussels:** Strand Lighting Ltd, Chaussée de Haecht 1801, 1130 Bruxelles, Belgium  
Tel: +32 (0) 2 245 8686 Fax: +32 (0) 2 245 2235

**Stockholm:** Strand Lighting Ltd, Box 20105, Tappvägen 24, 161 02 Bromma, Sweden  
Tel: +46 (0) 8 799 6950 Fax: +46 (0) 8 799 6954

ALSO FACILITIES IN: **LOS ANGELES • NEW YORK • HONG KONG • MILANO • MUNICH • BERLIN**

The Company reserves the right to make any variation in design or construction to the equipment described. © Strand Lighting Ltd 1995, Strand™, Strand Lighting™ Hyperbeam™ and Tracker™ are trade marks of Strand Lighting Limited. Strand Lighting is a company within the Film & Television Division of The Rank Organisation Plc, United Kingdom. Country of origin Denmark.