

Crown 1000FL Floodlights

Single: 201-200

A range of floodlights designed to project a high intensity, even wash of light, with a fixed beam angle. Used primarily for lighting cycloramas, backcloths, window and door backings, and general acting areas etc.

Maximum Lamp Size - 1000 watts

Beam Angle - 82°

Maximum Throw - 10 metres

Wire mesh safety screen, fitted as standard.

Available as single or multi compartment units.

Light-weight robust sheet steel construction.

Colour media pressure frame securely attached with toggle catch.

These floodlights are part of the Crown Range of luminaires, specifically designed for lighting performance areas.

Accessories

Plug Top : 5 amp - 141-002

Plug Top : 15 amp - 141-003

Pair of Feet - 069-400

Barn Door - Single Unit - 069-650

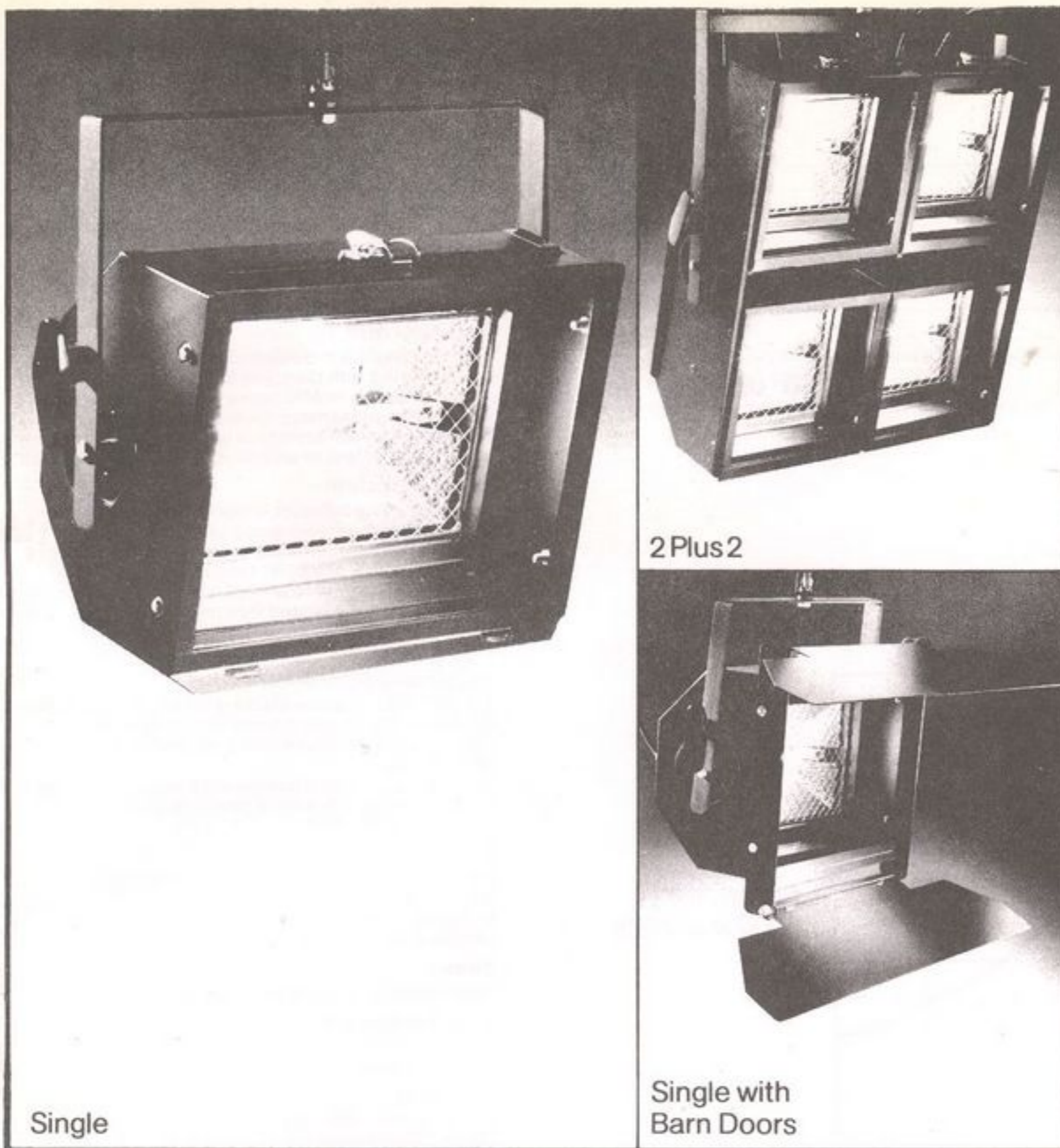

Single

2 Plus 2

Single with Barn Doors

Dimensions
N.T.S.

Environment
Classification
IP 20

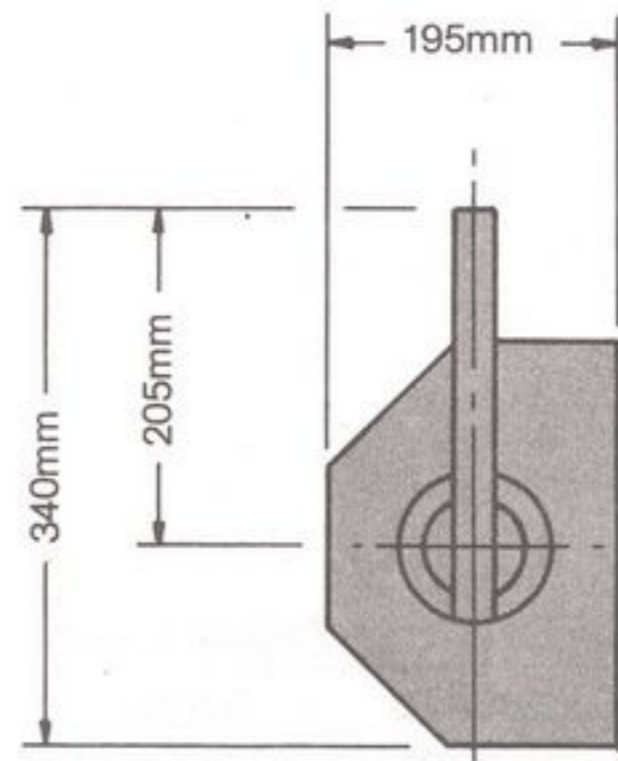
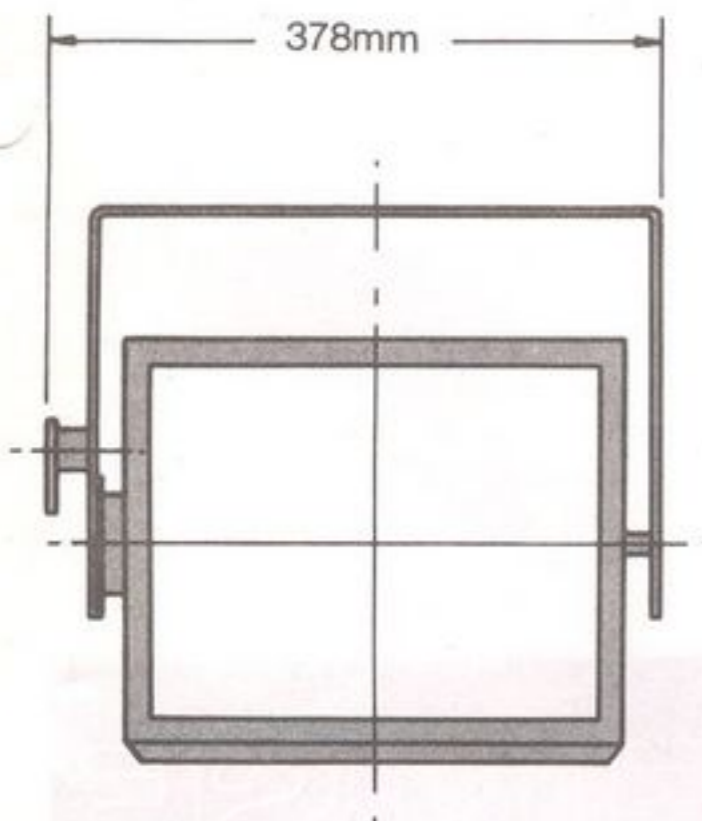

FURSE
THEATRE PRODUCTS

Traffic Street
Nottingham

Performance

Lamp Type	K4
Wattage	1000
Total Lumens (nominal)	21000
Rated Life (hours)	2000
Peak Illuminance at 5m throw (Lux)	255
Tilt	45° up to 90° down

Graphs Indicating Typical Performance Values

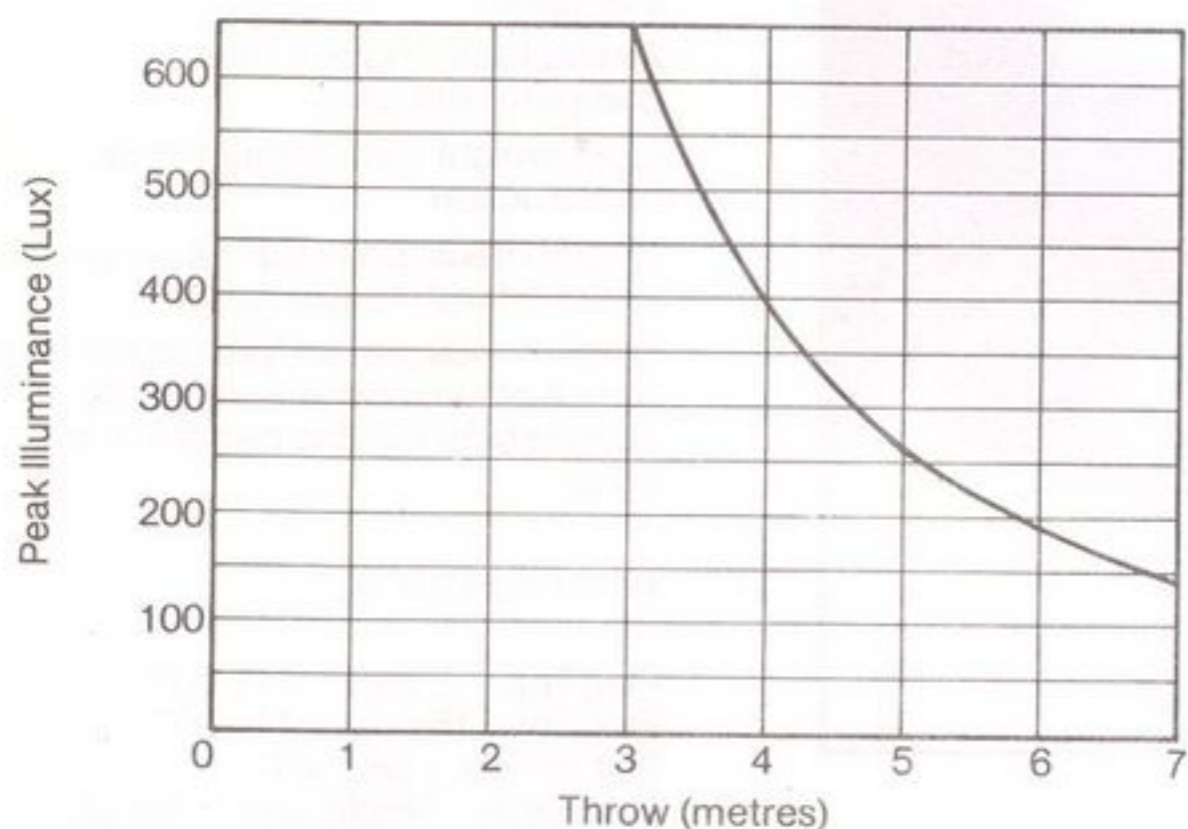

Lamp: K4
1000w @ 240v

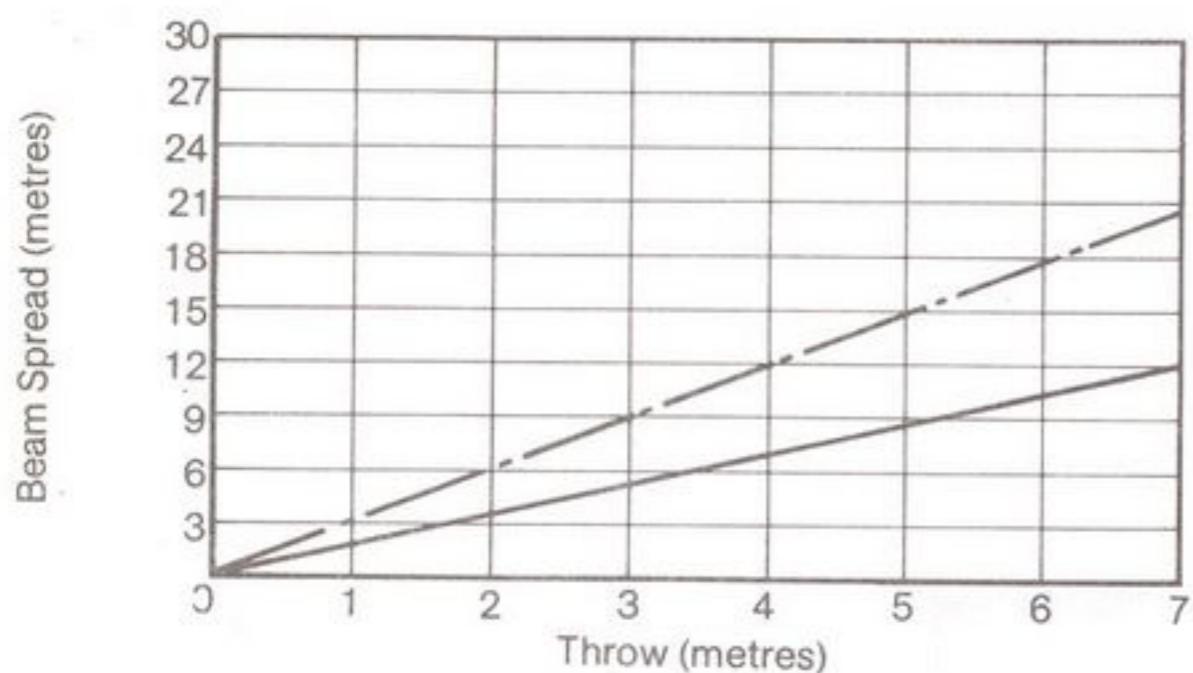

----- Field Angle (10% Peak Lux) 112°
 ————— Beam Angle (50% Peak Lux) 82°

1000 FL Specification

Body Construction

The luminaire is constructed from sheet steel pressings which are spotwelded together to form a rigid body. Adequate ventilation is provided to give maximum lamp life and internal baffles are fitted to reduce external surface temperatures and eliminate light leakage.

The single compartment body is designed as a basic module enabling multi compartment floodlights in various formats to be assembled.

Trunnion Arm

Each floodlight is provided with a steel trunnion arm which is fitted with clamping knob, to control the angle of tilt, and an M10 screw fixing complete with wing nut for suspension. Multi compartment floodlight trunnion arms also have two holes for the attachment of feet or additional suspension brackets.

Optical System

Reflector - The reflector is manufactured from high quality aluminium, embossed with a small hammer pattern, electro-chemically brightened and anodised.
Lampholder - A pair of R7 holders mounted on a bracket and spaced to accept a 189mm linear lamp.
Safety Screen - A hinged wire mesh panel is fitted to the front of the reflector assembly, thus totally enclosing the lamp.

Accessory Attachment

Colour Media - Colour Media is retained in position by means of a pressure frame which clips onto the bottom of the floodlight and is secured at the top with a toggle latch.
Barn Doors - Tapped bushes are provided in the end plates of all units (except 2 plus 2) to enable barn doors to be attached.

Electrical Connection

Each compartment is fitted with a length of 3 core silicon cable securely attached at the point of entry to the luminaires by means of a strain relief gland. Length of lead: Single Unit 1 metre.

Finish

Heat resisting textured semi matt black.

Suitable Lamps

K3 - 750 watt
 K9 - 1000 watt

Mounting

Barrel Clamp - 020-130
 Safety Chain (Heavy Duty) - 020-360
 Wall Bracket - 020-190
 Double Swivel Wall Bracket - 020-220
 Ceiling Mounting Bracket - 020-170
 Boom Brackets - 020-250

For details of above, see Theatre Fixing Leaflet.
 For freestanding applications, see Stand Leaflet.

Shipping Specification

Unit	Weight Exc. Lamp	Carton Size	Packed Weight
Single	4.1 Kg	400 x 350 x 240mm 0.034m ³	5.6 Kg

FURSE
THEATRE PRODUCTS

Traffic Street
Nottingham