

1200

1200 Condensor

The 1200 Condensor range offers four models of variable beam 1000/1200w condensor profile luminaires. Typically used in medium to large theatres, concert and entertainment venues for controlled illumination from auditorium and on-stage positions. The projector like optical system provides a very even field of light ideal for pattern projection and precise shaping of the beam.

FEATURES

- Available in 9°-21°, 12°-28°, 15°-31° and 28°-52° beam angles.
- Adjustable condensor optics allows fine tuning of light distribution and pattern focus.
- Very even field of light allows distortion free projection over the complete beam range.
- Interchangeable lens trays between 12°-28° and 15°-31° models, extends flexibility of the rig.
- Rotatable gobo holder, quickly and safely aligns pattern projections on stage.
- Cranked yoke with adjustable yoke balance point.
- 'Swing-down' door for easy access to lamp or cleaning.
- 'Posi-slide' focus system with no metal to metal contact provides smooth focus movement.
- Fully tested and compliant to CE standards

PHOTOMETRIC DATA

Tests conducted using a standard T29, 1200w, 240v, 27,600 lumens lamp.

Beam:	9° - 21°	12°-28°	15°-31°	28° - 52°
Narrow	347,900cd	279,000cd	208,250cd	67,500cd
Wide	140,140cd	75,600cd	61,740cd	23,250cd

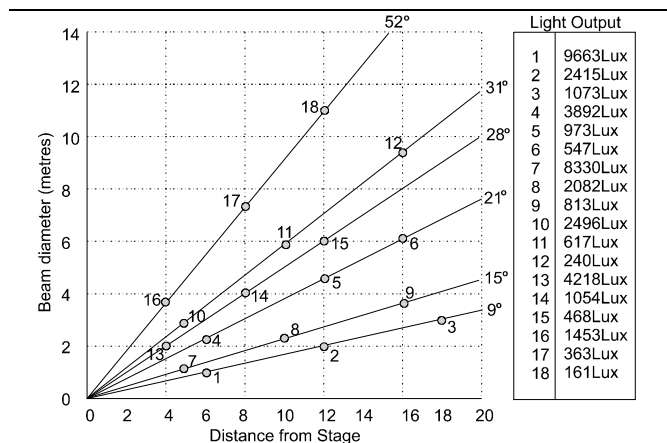

PHYSICAL DATA

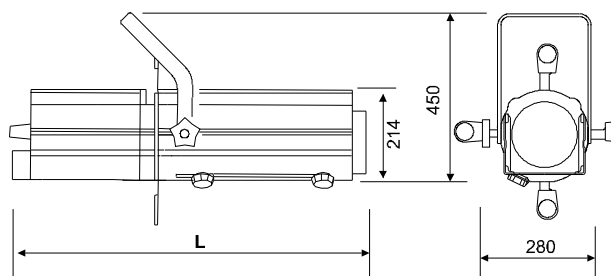

	9° - 21°	12°-28°	15°-31°	28° - 52°
Length:	915mm	830mm	830mm	620mm
Weight:	13.1Kg	13.1Kg	13.1Kg	11.9Kg
Packed:	17.0Kg	17.0Kg	17.0Kg	14.5Kg
Cubic:	0.076	0.076	0.076	0.057

Colour Frame Size: 185mm x 185mm (DIN std)

Pattern (Gobo) size : A

Included: 4 X shutters, 1 x colour frame, 1 x M12 nut & bolt set, instruction sheet.

ORDER CODES & ACCESSORIES

ZS1200 Condensor 9° - 21°	10CP1200N
ZS1200 Condensor 12° - 28°	10CP1200
ZS1200 Condensor 15° - 31°	10CP1200M
ZS1200 Condensor 28° - 52°	10CP1200W
1200 Iris	20IRIS
Rotatable Gobo Holder (A size)	20GHR
Rotatable Screw Clamp Gobo Holder	20GHSC
Lens Safety Mesh	20SM6
Suspension Hookclamp	20HC
Safety Bond	20SC

Your Selecon Distributor

