

new first floor throughout the building, hitherto a maze of up and down steps) as well as providing mixed seating positions for in-the-round performances in the centre of the auditorium. The second is the introduction of three small sets of retractable mobile rostrum at the back of the auditorium which can be easily repositioned or removed. The decor of the auditorium has another Greiner hallmark: a range of specially designed light fittings with hand blown glass globes from Venice which echo the period without slavishly copying it – a welcome change from those overpolished brass brackets designed for the irregular flecked light of gas but now supporting so

very much more lux.

In the account in CUE of the transformation of the St Lawrence I wrote that “it confirmed something I had long suspected, but had not the confidence to voice: we can put right the errors of the past. Transplants are possible. Perhaps there are other theatres closer to home which can be reborn ‘again’.” Two years later one can only repeat this, adding that if a sensitive, essentially humanist architect is to be selected for one of these transplants, then a visit to Enschede and an interview with Greiner who has built seven fine arts centres, should certainly be considered. Ironically there are currently six theatre

KEY

- |                                |                                   |
|--------------------------------|-----------------------------------|
| 1 Entrance                     | 26 see side stage main auditorium |
| 2 Box Office                   | 27 see main auditorium            |
| 3 Box Office                   | 31 Stores                         |
| 4 Foyer/hall                   | 33 Dressing rooms performers      |
| 5 Foyer                        | 34 Toilets                        |
| 6 Cloakroom                    | 36 Loge invalid                   |
| 7 Main auditorium              | 38 Stage manager                  |
| 8 Elevator                     | 42 Administration                 |
| 9 Stairs                       | 43 Bar and kitchen                |
| 10 Bookshop                    | 44 Coffee kitchen                 |
| 11 Foyer/cafe                  | 45 Kitchen                        |
| 15 Conference room             | 47 Performers foyer               |
| 16 Small auditorium            | 48 Lighting control               |
| 17 Stage main auditorium       | 49 Sound control                  |
| 18 Stage small auditorium      | 50 Elevator                       |
| 19 Balcony main auditorium     | 51 Stage elevator                 |
| 20 Boxes                       | 56 Circulation hall               |
| 21 Side stages main auditorium | 57 Emergency exit                 |
| 25 see stages main auditorium  |                                   |

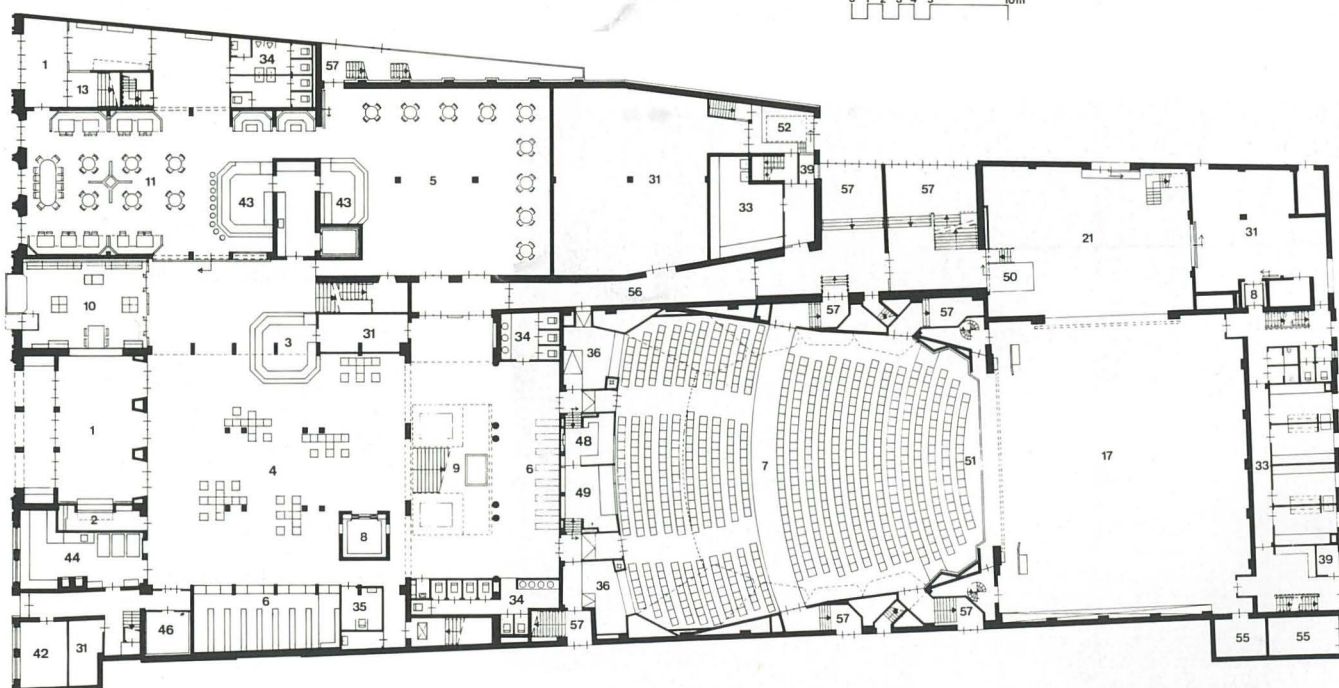
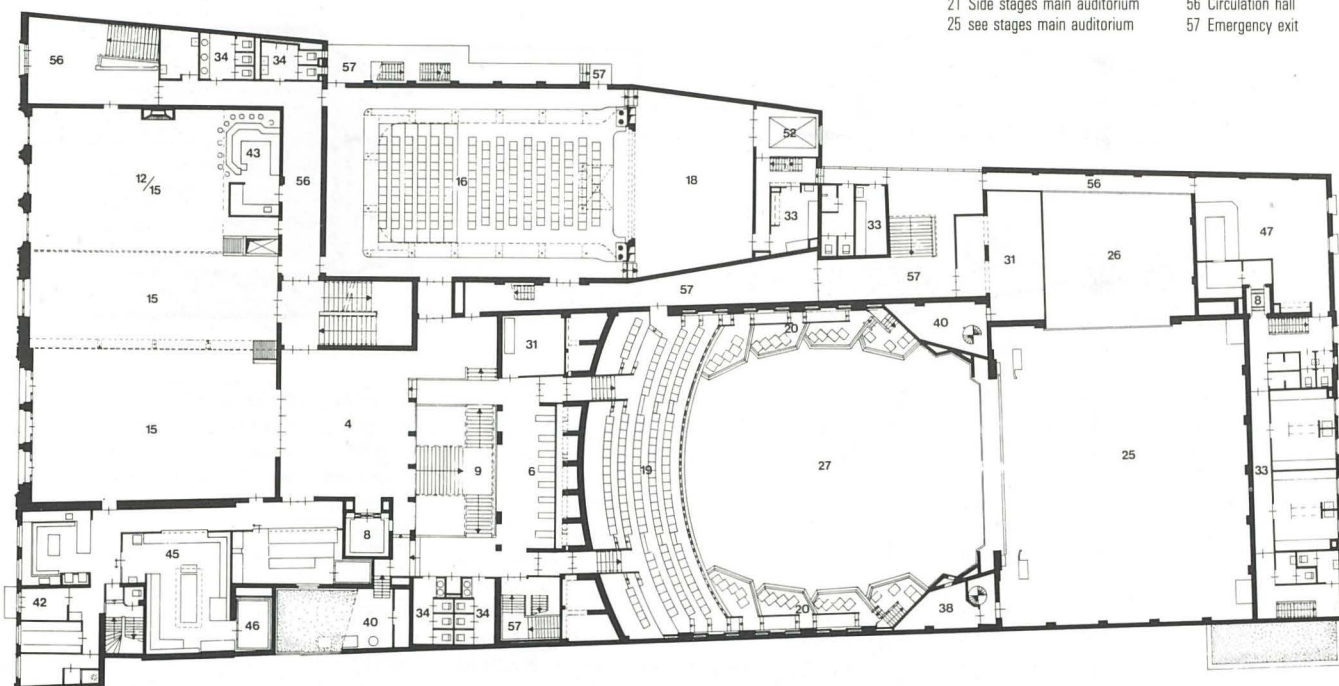

Plans of ground floor and first floor levels. Architects: Onno Greiner Martien Van Goor Architecten BV.