

The Ziller profile is available in straight or curved sections.

be keyed onto it from above or below. It is available in 18 metre lengths with three choices of curved section of different radius, for making wrap-around cycloramas for instance. The maximum point load to be suspended from this bow structure is 1500 N (335 lbs) and there are altogether 32 listed accessories. Lights are shown suspended from the bar on runners but the half round top profile would allow a modified conventional hook clamp to be used. Overall the Ziller Profile appears to be very versatile – we would however question whether it can be used for short bar extensions in an overhang situation and still maintain its strength. Potentially, a bow which doubles as a tab track would save much time and storage in touring theatres and it would be interesting to see a grid full of Ziller in one of this country's large and busy theatres.

A. Fechoz – Paris

This company has handled some very large projects i.e. The National Theatre of Baghdad, and its two language catalogue lays emphasis on the comprehensive design service offered to Architects and Consultants by the company. Via powered

flying at the Comédie Francaise and another National Theatre, this time at Lagos, we come to a range of equipment which could well permeate into British Theatre – marketed under the names of Praticabloc and Modulpratic. Fechoz also make a stacking seating system with telescopic steps in block modules of up to six

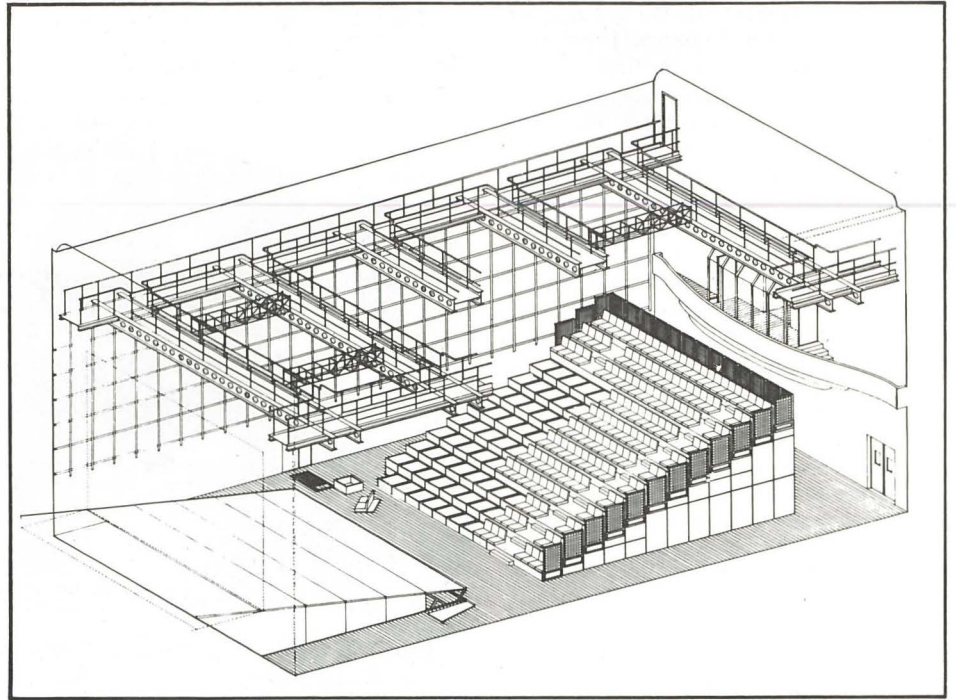

Axonometric showing possible arrangements in a multi-purpose hall using the Praticabloc system.

# CUE SUBSCRIPTION FORM

To Twynam Publishing Ltd., Kitemore, Faringdon, Oxfordshire SN7 8HR.

Please send CUE Magazine for one year (6 issues) and –

1. I enclose my cheque/postal order for \*£ \_\_\_\_\_
2. Please send me an invoice to the address below
3. Please send me a bankers order form to the address below
4. I authorise you to debit my credit card account with \*£ \_\_\_\_\_ My Barclaycard/Visa/Access account number is

--	--	--	--	--	--	--	--	--	--	--	--

\*Subscription rates are overleaf

NAME (Mr. Mrs. Miss). \_\_\_\_\_

ADDRESS: \_\_\_\_\_

\_\_\_\_\_

SIGNATURE: \_\_\_\_\_

DATE: \_\_\_\_\_

Receipts sent if specifically requested.

seats wide by eight rows deep, plus additional triangular sections for instances where rows butt up to one another at an angle, and sections for half stepped aisles. The seats fold down into the step-block for use in exhibitions or school activities, or can in turn move back under the next row, until the whole tier is in one vertical stack, leaving a clear floor area. The drawback to this form of seating – a great space creator for Multi-purpose halls – would seem to be the lack of arms on the seats.

Modulpratic (mentioned earlier) is a complete range of modular shapes or drama blocks which can be slotted together to make a wide variety of stage or auditorium shapes. Handrail and seating modules are proposed. At present the range is under development but when it is available in all its forms, Modulpratic should be a staging medium equally at home supporting Brecht at the local Arts Centre or the raucous burden of the School Pop group.

Praticabloc is the middleman between the stacking seating and the Modulpratic system. There are single rise square blocks (300mm high × 900 × 900) which can have fitted seats or half steps for aisles, with rigid metal frames for raising the block in multiples of 300mm (11.8 inches). To complete the auditorium section, handrails with grille sides are slotted into the sides of the blocks and grilles mask off the void beneath.