

LEKOLITE[®]

6", 8" and 10" fixed focus ellipsoidals

500W - 1000W

- ❑ Updated range of seven fixed angle 1000W ellipsoidal spotlights
- ❑ Accepts either high efficiency FLK (HX600) or high output FEL lamps
- ❑ Four interchangeable lens tubes, 20°, 30°, 40°, 50°
- ❑ High angularity gate with overlapping shutter blades, each with 100° movement
- ❑ High-output, short length, fast focusing
- ❑ Simple lamp replacement possible without disturbing lamp setting
- ❑ Patented lamp centering mechanism
- ❑ Optional rotatable pattern holder or drop-in iris
- ❑ UL and CSA approved
- ❑ Supplied with color frame, mounting yoke with C-clamp, and 3' (0.9m) power cable with bare leads or connector specified
- ❑ Can be used for 220V operation



Leko 5

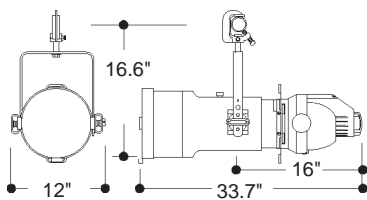

Leko 10

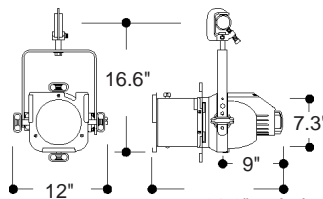
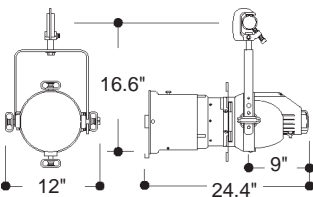

Leko 50
Leko 40
Leko 30
Leko 20
Leko 15

21.8" - Leko 50
Leko 40
Leko 30
Leko 20
27.2" - Leko 15

Weights and Dimensions

	Leko 5	Leko 10	Leko 15	Leko 20,30,40,50
Weight	26lb (11.8kg)	22lb (10kg)	17.2lb (7.8kg)	13.2lb (6.0kg)
Packed weight	30.8" (14kg)	26.4" (12kg)	18.9lb (8.6kg)	14.9lb (6.8kg)
Packed depth	14.7" (375mm)	12.8" (325mm)	12.2" (305mm)	12.2" (305mm)
Packed width	14.7" (375mm)	12.8" (325mm)	12.0" (300mm)	12.0" (300mm)
Packed height	39" (990mm)	30.3" (770mm)	32.0" (800mm)	27.6" (690mm)

Photometric Data

Leko 5

Distance (ft)	80	90	100	120	140
Beam Ø (ft)	7	7.8	8.7	10.5	12
Illum (FC Pk)	137	108	88	61	45

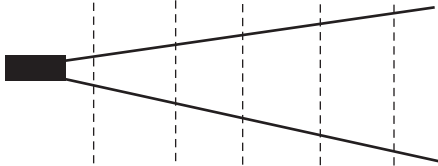

Leko 15

Distance (ft)	50	55	60	70	80
Beam Ø (ft)	13	14.5	16	18.5	21
Illum (FC Pk)	77	63	53	39	34

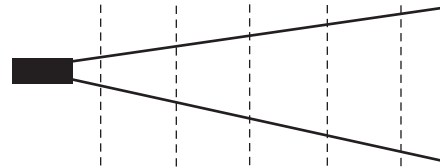

Leko 10

Distance (ft)	60	70	80	90	100
Beam Ø (ft)	10.5	12	14	15.7	17.5
Illum (FC Pk)	164	120	91	72	59

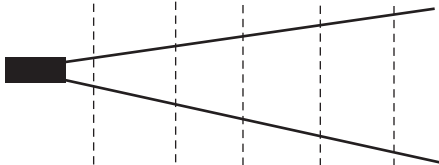

Leko 20

Distance (ft)	45	50	55	60	70
Beam Ø (ft)	16	18	19.5	21	25
Illum (FC Pk)	92	74	62	52	44

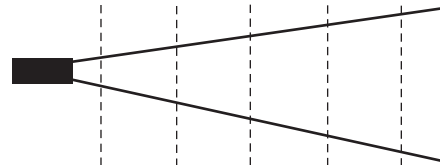

For performance with HX600 lamp use .7 multiplication factor

Leko 30

Distance (ft)	45	50	55	60	70
Beam Ø (ft)	24	27	29	32	38
Illum (FC Pk)	86	70	58	48	41

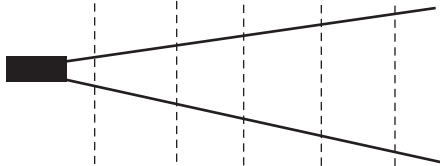

Leko 50

Distance (ft)	30	35	40	45	50
Beam Ø (ft)	28	33	37	42	47
Illum (FC Pk)	70	51	39	31	25

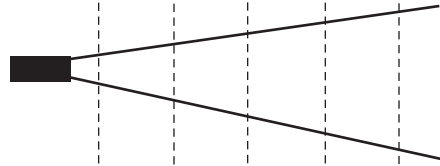

Leko 40

Distance (ft)	35	40	45	50	55
Beam Ø (ft)	25	29	33	36	40
Illum (FC Pk)	97	74	58	47	39

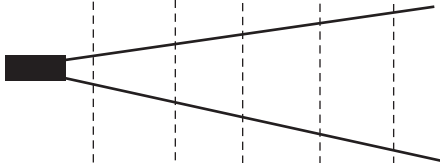

Operational features

Focus Adjustment

By cross head screwdriver. Axial plane to vary distribution. Transverse plane to vary center the lamp.

Beam Shaping

Four shutters in two independent planes allowing 100° rotation about the light axis of each shutter.

Lamp Access

Removable socket assembly.

Electrical & mechanical data

Construction

Diecast aluminum with black epoxy powder coat paint finish.

Lens(es)

Two 6 inch (152mm) diameter Plano-convex (Leko 50/40/30/20/15). One 8" (200mm) Plano convex (Leko 10). One 10" (259mm) Plano convex (Leko 5).

Reflector

Double flatted near-ellipsoidal reflector of polished, anodised aluminum.

Mounting/Suspension

Steel yoke assembly with malleable iron C-clamp.

Pattern/Gobo Size

A

Standards Compliance

UL/CSA listed.

Supply Voltage

120/220V 50/60Hz

Ordering information

Upgraded 1000W Leko with fixed beam spread. Supplied with color frame and C-clamp.

Cat No	Description	Optional accessories
12430	5° Leko, bare leads	FLK 575W 115V Lamp 300hrs
12410	10° Leko, bare leads	FLK/LL 575W 115V Lamp 1500hrs
12215	15° Leko, bare leads	FEL 1000W 120V Lamp
12220	20° Leko, bare leads	CP77 1000W 220V Lamp
12230	30° Leko, bare leads	18220 Additional 20° Lens Tube
12240	40° Leko, bare leads	18230 Additional 30° Lens Tube
12250	50° Leko, bare leads	18240 Additional 40° Lens Tube
		18250 Additional 50° Lens Tube
		18105 Additional color frame, 71/2" x 71/2"
		18108 High hat, 6" Leko
		18102 Drop-in iris
		18101 Rotatable Pattern holder
		18109 Additional color frame, 10" x 10" (Leko 10)
		18110 Additional color frame 113/4" x 113/4"(Leko 5)
		18111 High Hat (Leko 10)
		18112 High Hat (Leko 5)
		82003 Safety cable, 18" (457mm)

The Company reserves the right to make any variation in design or construction to the equipment described. © Strand Lighting Ltd 1998. Strand™ and Strand Lighting™ are trade marks of Strand Lighting Limited and Strand Lighting Inc.

Strand Lighting Inc

PO Box 9004 18111 South Santa Fe Avenue Rancho Dominguez CA 90221, USA Tel: +1 310 637 7500 Fax: +1 310 632 5519

Second Floor 151 West 25th Street New York NY 10001, USA Strand Lighting Inc Tel: +1 212 242 1042 Fax: +1 212 242 1837

Eclairages Strand (Canada) Inc 2430 Lucknow Drive No 15 Mississauga Ontario L5S 1V3 Canada Tel: +1 905 677 7130 Fax: +1 905 677 6859