



Strand Lighting

PRODUCT DATA

Redhead 3 Kit

Comprises 3 Redheads with safety glass and DXX 800W lamps, 3 accessory holders, 3 barndoors, scrim set (1 each of full double, full single, half double, half single), Reflector pack (gold), 3 Spartan stands, and a deluxe kit case.

Cat. No.	Description
23034	Redhead 3 Kit, 240V
23033	Redhead 3 Kit, 230V

Redhead 4 Kit

Comprises 4 Redheads with safety glass and DXX 800W lamps, 4 accessory holders, 4 barndoors, scrim set (1 each of full double, full single, half double, half single), Reflector pack (gold), 3 Spartan stands, gaffer grip, and a kit case.

Cat. No.	Description
23044	Redhead 4 Kit, 240V
23043	Redhead 4 Kit, 230V

Single Blonde Kit

Comprises a single Blonde with safety glass and FEX 2000W lamp, barndoor, and scrim set (1 each of full double, full single, half double, half single) in a kit case.

Cat. No.	Description
23014	Single Blonde Kit, 240V
23013	Single Blonde Kit, 230V

Double Blonde Kit

Comprises 2 Blonde heads with safety glass and FEX 2000W lamps, 2 barndoors, and scrim set (1 each of full double, full single, half double, half single) in a kit case.

Cat. No.	Description
23024	Double Blonde Kit, 240V
23023	Double Blonde Kit, 230V

ENG Kit 1

Comprises 3 Pulsar heads with safety glass and A1/233 650W lamps, 3 barndoors, scrim set (1 each of full double, full single, half double, half single), 3 Mercury stands, reflector pack and a deluxe outfit case.

Cat. No.	Description
23114	ENG Kit 1, 240V
23113	ENG Kit 1, 230V

ENG Kit 2

Comprises 2 Pulsar heads with safety glass and A1/233 650W lamps, 1 Mizar with CP82 500W lamp, 3 barndoors, scrim set (1 each of full double, full single, half double, half single), 2 Mercury stands, gaffer grip, reflector pack and a deluxe outfit case.

Cat. No.	Description
23124	ENG Kit 2, 240V
23123	ENG Kit 2, 230V

ENG Kit 3

Comprises 1 Pulsar head with safety glass and A1/233 650W lamp, 2 Mizars with CP82 500W lamps, 3 barndoors, scrim set (1 each of full double, full single, half double, half single), 2 Mercury stands, gaffer grip, reflector pack and a deluxe outfit case.

Cat. No.	Description
23134	ENG Kit 3, 240V
23133	ENG Kit 3, 230V

ENG Kit 4

Comprises 2 Pulsar heads with safety glass and A1/233 650W lamps, 1 ladi Fill with opal glass, P2/20 1000W lamps, plus full double scrim and full single scrim, 2 Pulsar barndoors, scrim set for Pulsars (1 each of full double, full single, half double, half single), set of barndoor reflectors for ladi, 3 Spartan stands, reflector pack and a deluxe outfit case.

Cat. No.	Description
23144	ENG Kit 4, 240V
23143	ENG Kit 4, 230V

ENG Kit 5

Comprises 1 Pulsar head with safety glass and A1/233 650W lamp, 2 ladi Fill with opal glass, P2/20 1000W lamps, plus full double scrim and full single scrim, 1 Pulsar barndoor, scrim set for Pulsar (1 each of full double, full single, half double, half single), set of barndoor reflectors for ladi, 3 Spartan stands, reflector pack and a deluxe outfit case.

Cat. No.	Description
23154	ENG Kit 5, 240V
23153	ENG Kit 5, 230V

ENG Kit 6

Comprises 2 Redheads with safety glass and DXX 800W lamps, 2 ladi Fill with opal glass, P2/20 1000W lamps, plus full double scrim and full single scrim, set of barndoor reflectors for ladi, 2 Redhead accessory holders, 2 barndoors for Redheads, scrim set for Redheads (1 each of full double, full single, half double, half single), 3 Spartan stands, reflector pack and a deluxe outfit case.

Cat. No.	Description
23164	ENG Kit 6, 240V
23163	ENG Kit 6, 230V

2.6.2

PORTABLES

REDHEAD™ KITS

800W

BLONDE™ KITS

2000W

ENG KITS

Kits 1-6

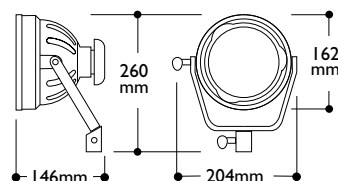

Redhead

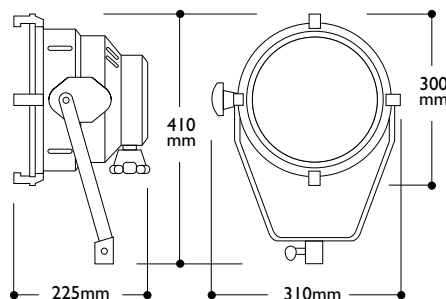

Blonde

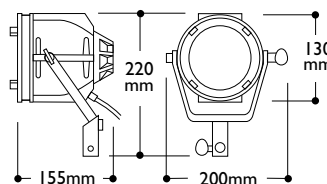

Pulsar

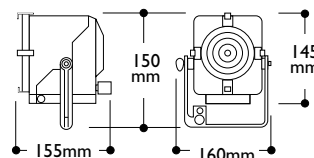

Mizar

A GUIDE TO SYMBOLS AND ABBREVIATIONS

GENERAL ∇ Supply voltage Δ Current rating \square Weight of product \square Packed weight \square Packed volume \blacksquare Overall dimension of product \checkmark Compliance with international standards. \square Watts (maximum recommended) \sphericalangle Beam angle \blacktriangleleft Throw (usual working distance from subject in metres) \ast Illuminance (maximum lux at throw distance stated with lamp recommended or supplied) ∇ Colour filter cut size ENG Electronic News gathering IP International Protection (Ingress protection standard for dust, solids and moisture) IEC529

- A range of lightweight and compact kits
- Ideal for ENG, film and video lighting
- Suitable for location and studio use
- Featuring the versatile range of Quartzcolor fresnel and open faced luminaires
- Range of units from 300W to 2000W
- Convenient transportable cases
- Developed for fast set-up and re-packing

Photometric Data

Typical performance based on A1/223 650W lamp

Pulsar 650W

Throw (metres)	2		3		4		5	
	Lux	Ø	Lux	Ø	Lux	Ø	Lux	Ø
Flood 70°	2030	2.8	900	4.2	500	5.6	325	7.0
Spot 27.5°	9350	1.0	4155	1.5	2340	2.0	1500	2.5

Flood: Performance at any distance $8130 \div \text{Distance}^2$ Spot: Performance at any distance $37400 \div \text{Distance}^2$

Typical performance based on P2/13 800W lamp

Redhead 800W

Throw (metres)	2		3		4		5		6	
	Lux	Ø	Lux	Ø	Lux	Ø	Lux	Ø	Lux	Ø
Flood 87°	2095	3.8	910	5.7	515	7.6	330	9.5	230	11.4
Spot 47°	6675	1.7	2970	2.6	1670	3.5	1070	4.4	740	5.2

Flood: Performance at any distance $8220 \div \text{Distance}^2$ Spot: Performance at any distance $26700 \div \text{Distance}^2$

Typical performance based on FEX 2000W lamp

Blonde 2000W

Throw (metres)	3		4		5		6		7	
	Lux	Ø	Lux	Ø	Lux	Ø	Lux	Ø	Lux	Ø
Flood 72°	2780	4.4	1560	5.8	1000	7.3	695	8.7	510	10.2
Spot 27°	14600	1.4	8190	1.9	5240	2.4	3640	2.9	2670	3.4

Flood: Performance at any distance $25000 \div \text{Distance}^2$ Spot: Performance at any distance $131000 \div \text{Distance}^2$

Typical performance based on CP82 500W lamp

Mizar 500W

Throw (metres)	3		6		9		12	
	Lux	Ø	Lux	Ø	Lux	Ø	Lux	Ø
Flood 41.5°	850	2.3	215	4.5	95	6.8	55	9.1
Spot 14°	2800	0.75	700	1.5	310	2.2	175	3.0

Flood: Performance at any distance $7650 \div \text{Distance}^2$ Spot: Performance at any distance $25200 \div \text{Distance}^2$

Ø Beam diameter in metres

Typical performance based on P2/20 1000W lamp

Iadi 1000W

Throw (metres)	2		4		6		18	
	Lux	Spread	Lux	Spread	Lux	Spread	Lux	Spread
Vertical 76°	3100	3.1	775	6.2	340	9.3	190	12.4
Horizontal 91°		4.0		8.0		12.0		16.0

Performance at any distance : Vertical $12400 \div \text{Distance}^2$ Performance at any distance : Horizontal $12400 \div \text{Distance}^2$ **Lamp Data**

	Mizar		Iadi	Pulsar
Watts	500W	300W	1000W	650W
Designation	CP82	CP81	P2/20	A1/233
Base	GY9.5	GY9.5	R7s	GZ9.5
Lumens	12500	6900	25500	16500
Rated Life-Hours	150	150	200	50
Colour Temp	3200K	3200K	3200K	3200K

	Redhead 800	Redhead 1000	Redhead 2000
Watts	800W	1000W	2000W
Designation	P2/13	P2/35	P2/27
Base	R7s	R7s	R7s
Lumens	21400	26500	50000
Rated Life-Hours	75	150	300
Colour Temp	3200K	3200K	3200K

Note: A 250W, 24V lamp is available for the Fire Brigade Redhead.



London: Strand Lighting Ltd, Grant Way, Isleworth, Middlesex, TW7 5QD, United Kingdom.
Tel: +44 (0)181 560 3171 Fax: +44 (0)181 568 2103

Wolfenbüttel: Strand Lighting GmbH, Salzbergstraße 2, 38302 Volfenbüttel, Germany.
Tel: +49 (0) 5331 3008-8 Fax: +49 (0) 5331 78883

Rome: Strand Lighting Srl, Via delle Gardenie 33, Pontina Vecchia Km 33,400, 00040 Pomezia-Roma, Italy
Tel: +39 (0) 6 914 7123 Fax: +39 (0) 6 914 7136

Brussels: Strand Lighting Ltd, Chaussée de Haecht 1801, 1130 Bruxelles, Belgium
Tel: +32 (0) 2 245 8686 Fax: +32 (0) 2 245 2235

Stockholm: Strand Lighting Ltd, Box 20105, Tappvägen 24, 161 02 Bromma, Sweden
Tel: +46 (0) 8 799 6950 Fax: +46 (0) 8 799 6954

ALSO

FACILITIES IN: LOS ANGELES • NEW YORK • HONG KONG • MILANO • MUNICH • BERLIN

© Copyright Strand Lighting Limited November 1995

Electrical Data

Supply Voltage	230/240V 50/60Hz
Cable and Switching	Mizars*, Pulsar, Iadi & Redhead: 4.0m 3 x 1.5mm ² cable (Ø3.5mm) with in-line switch. Blonde 2K: 5.5m 3 x 2.5mm ² cable with in-line switch.
Standards Compliance	EN60 598 2-17.

Environmental Data

Max Operating Ambient Temp	45°C
IP Rating	IP20
Tilt/Recommended angles of use	90° - 0 - 90°

Mechanical Data

Paint/Finish	Mizar & Iadi: Extra high temperature paint Redhead 800, 1000 & Pulsar: Self-coloured Blonde: Heat resistant yellow paint.
Lamp House	Mizar: Pressure diecast in aluminium. Iadi: Steel construction vented for cooling with integral four way barndoors. Pulsar, Redhead 800 & 1000 Self-coloured, lightweight heat resisting glass reinforced polyester resin. Blonde 2K: Pressed steel and aluminium.
Lens	Mizar: Heat resistant borosilicate. 80mm.
Reflector	Mizar: Hemispherical anodised aluminium reflector optimised for lamp/lens combination. Iadi: One piece symmetrical aluminium. Pulsar and Redhead and Blonde: Compound parabolic anodised aluminium specially textured for smooth beam distribution.
Mounting/Suspension	Mizar: Cast aluminium stirrup with offset 16mm socket. Iadi and Blonde: Cast aluminium stirrup with 16mm socket. Pulsar and Redheads 800 & 1000: Glass reinforced plastic stirrup with 16mm socket.

Weights and Dimensions

	Weight	Case Size W x H x D
Redhead 3 Kit	16.0kg	800 x 260 x 400mm
Redhead 4 Kit	20.5kg	1000 x 290 x 350mm
Single Blonde Kit	10.0kg	400 x 360 x 400mm
Double Blonde Kit	18.0kg	780 x 380 x 400mm
ENG Kit 1	14.0kg	560 x 240 x 450mm
ENG Kit 2	13.5kg	560 x 240 x 450mm
ENG Kit 3	13.5kg	560 x 240 x 450mm
ENG Kit 4	16.5kg	800 x 260 x 400mm
ENG Kit 5	17.0kg	800 x 260 x 400mm
ENG Kit 6	21.5kg	1000 x 290 x 350mm

Operational Data

Lamp Access	Mizar: Through hinged rear half which is released by 1/4 turn screw. All other units after removal of safety screen.
Focus Adjustment	Mizar, Pulsar & Redhead: By rear facing rotary control and helical screw mechanism. Blonde: Rotary control on the underside of the fixture moves reflector relative to the lamp. Iadi is fixed focus.
Accessory fitting	Mizar: Drop-in accessories with spring loaded top catch for retention. Redheads: By detachable accessory holder. Pulsar & Blonde: Integral accessory holder.

The Company reserves the right to make any variation in design or construction to the equipment described. © Strand Lighting Ltd 1995. Strand™, Strand Lighting™, Mizar™, Pulsar™, Pinza™, Iadi™, Blonde™ and Redhead™ are trade marks of Strand Lighting Limited and Strand Lighting Inc. Strand Lighting is a company within the Film & Television Division of The Rank Organisation Plc, United Kingdom. Country of origin Italy.