

STRAND FOCUS LANTERNS

PATTERN 43 B STAGE SPOT, 1000 Watt

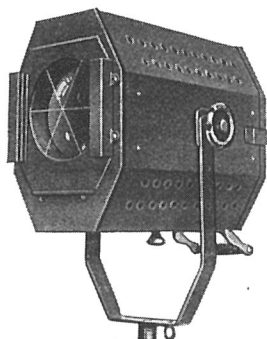

This Spotlight is suitable for all general stage purposes, and may be used as a F.O.H. focus lamp. Also suitable for CABARET work, etc.

SPECIFICATION

Lantern constructed in sheet steel, efficiently ventilated. Access to lamp by hinged door at rear. 6 in. diameter, 10 in. focus plano-convex lens. Type 43 tray, giving vertical and axial adjustment for lamp filament, complete with spherical chromium-plated reflector. Focusing by knob under lantern. Runners to take millboard colour frames on front. Tilting fork and 3 in. diameter locking wheels. Removable handle at rear. Finish, black crystalline enamel outside, matt black inside.

PRICE (exclusive of Lamp) ... ~~£4 12 6~~ ⁶⁻⁰⁻⁰

	£	s.	d.	
C 60 Light Pattern Telescopic Stand (Min. height 4 ft. 3 in., Max. 7 ft. 0 in.)	1	2	6	each 1-5-0
C 225 Linen bound millboard colour frames (8½ in. x 7½ in.)	7	6		per doz. 8-3
C 226 Ditto, with assorted gelatines	10	0		" 11-0
C 227 Ditto, with assorted "Chromoid" colours (see page 98)	17	9		" 16-6
C 88 Spotting attachment with four masks, giving four sizes of spots (weight 5½ lbs.)	2	0	0	each 3-0-0
C 64 Safety chain with snap hook	2	0		" 2-3
C 84 Adjustable barrel clamp	5	6		" 7-6
C 65 "L" clamp for 1½ in. barrel	2	6		" 2-9
Extra Price for fitting switch to Lantern for cabaret work	5	0		Nett 10-0 N

Lamp: 1000 watt Class A I Tubular or Class B Round
Bulb Projector. G.E.S. Cap (see page 103).

Beam Angle: Maximum 42°, Minimum 13°.
Effective throw 60 ft.

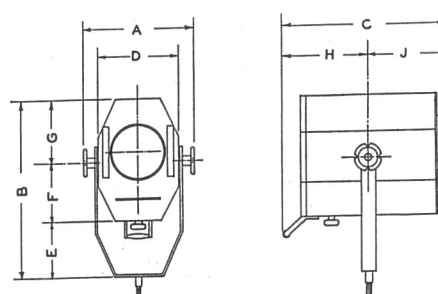

DIMENSIONS. PATTERN 43B

	Ft.	In.		Ft.	In.
A	1	0½	F	6	¾
B	1	8	G	6	¾
C	1	5½	H	8	¾
D	9		J	8	¾
E	6	½			

Nett weight of Lantern, 25 lbs.

Telephone:
Temple Bar 7464 (6 lines).

STRAND ELECTRIC
AND ENGINEERING CO., LTD.
FLORAL STREET, COVENT GARDEN, W.C.2

Telegraphic Address:
Spotlite, Rand, London.