

Theatre Royal, Hobart restored 1986 with a rebuilt and heightened stage house to accommodate a modern scenery flying system.

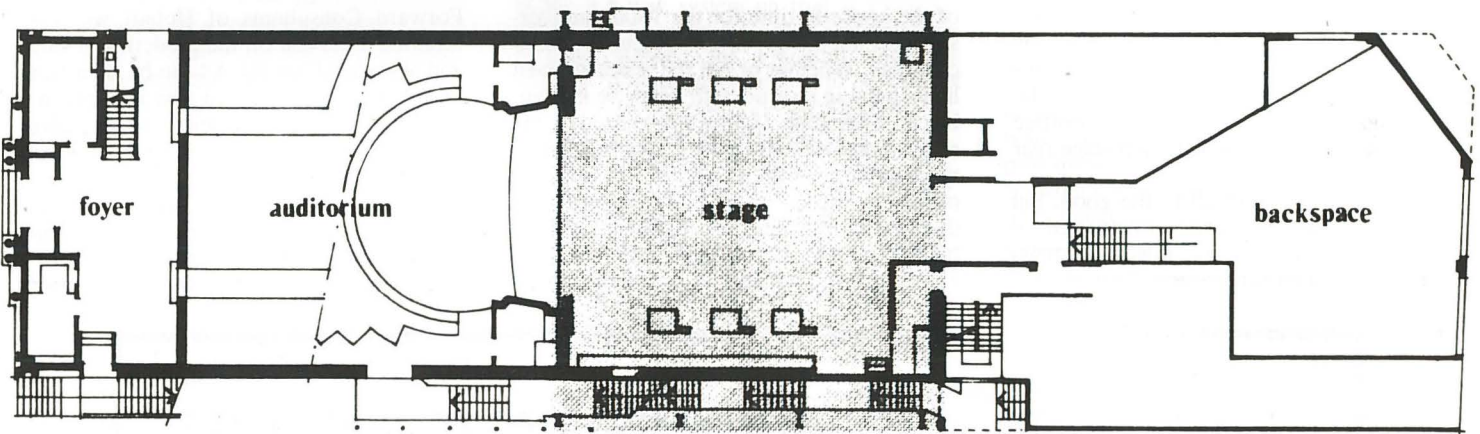

THEATRE ROYAL in HOBART, TASMANIA

stage floor level plan

0 2 4 6 8 m

**Forward Consultants
Entertech Pty Ltd.**

KEY

- | | | |
|--|--|---|
| 1. New Fly tower structure, replaces existing roof | 10. Plant room - heating and ventilating new stage house | 18. Stage Technician |
| 2. Grid floor and Counterweight loading gallery | 11. Lighting and Audio control boxes front of house | 19. ABC outside broadcast |
| 3. Fire Curtain | 12. Backstage: waiting to go on | 20. Follow spots |
| 4. House Curtain | 13. Scenery loading bay and hoist | 21. Tourists looking for Ghosts in "The Shades" |
| 5. Counterweight scenery flying | 14. Pit hoist raises floor to stage level | |
| 6. New Stage lighting | 15. 35 piece orchestra pit enlarged | |
| 7. New drapes, legs and borders | 16. Dimmer racks for lights | |
| 8. Fly gallery | 17. The green room | |

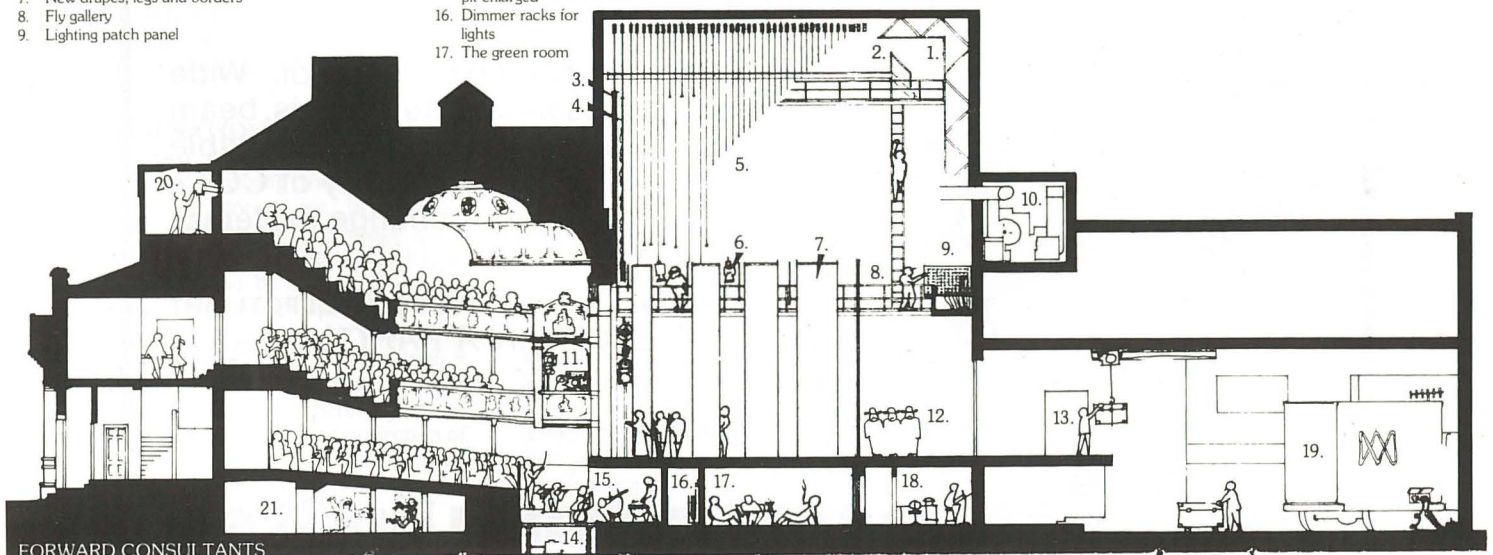

FORWARD CONSULTANTS